



NOTICE OF MEETING

Meeting:	Licensing Hearings
Date and Time:	Wednesday, 7th June, 2023 at 11.00 am
Place:	Council Chamber
Enquiries to:	committeeservices@hart.gov.uk
Members:	Smith, Collins and Delaney

Chief Executive

CIVIC OFFICES, HARLINGTON WAY
FLEET, HAMPSHIRE GU51 4AE

AGENDA

This Agenda and associated appendices are provided in electronic form only and are published on the Hart District Council website.

- Please download all papers through the Modern.Gov app before the meeting.**
- At the start of the meeting, the Lead Officer will confirm the Fire Evacuation Procedure.**
- The Chairman will announce that this meeting may be recorded and that anyone remaining at the meeting has provided their consent to any such recording - Please see our protocol on [Attending and Reporting Meetings](#).**

1 APPOINTMENT OF CHAIRMAN

2 DECLARATIONS OF INTEREST

3 APPLICATION FOR PREMISES LICENCE - LIQUOR AND VAPE STORE, 158 ALDERSHOT ROAD, CHURCH CROOKHAM, FLEET, GU52 8JT 3 - 60

To consider and determine an application for a new premises licence for Liquor and Vape Store, 158 Aldershot Road, Church Crookham, Fleet, GU52 8JT in accordance with the requirements of the Licensing Act 2003.

Date of Despatch: Tuesday, 30 May 2023

LICENSING SUB-COMMITTEE

DATE OF MEETING: Wednesday 7 June 2023

TITLE OF REPORT: APPLICATION FOR PREMISES LICENCE - LIQUOR and VAPE STORE, 158 ALDERSHOT ROAD, CHURCH CROOKHAM, FLEET, GU52 8JT

Report of: Executive Director, Place

1 PURPOSE OF REPORT

1.1 This report is to enable members to consider and determine an application for a new premises licence for Liquor and Vape Store, 158 Aldershot Road, Church Crookham, Fleet, GU52 8JT in accordance with the requirements of the Licensing Act 2003.

2 OFFICER RECOMMENDATION

2.1 It is recommended that:

The sub-committee consider the evidence of all parties involved at the hearing and have regard to the guidance issued under section 182 of the Licensing Act 2003 and the council's statement of licensing policy, then take the steps it considers appropriate to promote the licensing objectives to determine the application.

2.2 It is for members of the Licensing Sub-Committee to determine the application and consider the steps it considers appropriate for the promotion of the licensing objectives which may include one or more of the following options (s18(4)):

- Grant the licence subject to:
 - 1) The conditions consistent with the operating schedule accompanying the application modified to such an extent as the authority considers appropriate for the promotion of the licensing objectives and
 - 2) Any mandatory conditions which must under section 19 (relating to the sale of alcohol) and 21 (relating to door supervision) of the Licensing Act 2003 which must be included in the licence if relevant to the proposed activities.
- Exclude from the scope of the licence any of the licensable activities to which the application relates
- Refuse to specify a person in the licence as the premises supervisor
- Modify the conditions of the licence or add new conditions
- Reject the whole or part of the application

2.3 When determined, the licensing authority must notify that decision including its reasons for the decision in a notice to:

- a) The applicant
- b) Any person who has made relevant representations, and
- c) The chief officer of Police for the area in which the premises is situated.

2.4 If granting the application, the notice must specify the time when the variation in question takes effect. That time is the time specified in the application or, if that time is before the applicant is given that notice, such later time as the relevant licensing authority specifies in the notice.

2.5 An appeal against the decision made in determining this application may be made to the Magistrates Court within 21 days of all parties being notified of the local authority's decision

3 BACKGROUND

3.1 An application for a new premises licence was received 12 April 2023. The application is for an off licence (sale of alcohol by retail for consumption off the premises only). The premises previously operated as an off licence for several years trading as Wine Rack, Threshers and latterly as Wine Shack until it closed in 2013 and did not re-open.

It is situated in close proximity to three further commercial premises; Church Crookham pharmacy located at 157 Aldershot Road, Ho's Fish Bar at 162 Aldershot Road, and a currently vacant retail unit at 164 Aldershot Road.

The application can be found at Appendix 1 and the internal layout plan at Appendix 2

The proposed licensable activities are as follows:

Proposed licensable activities	Proposed times
The Sale of Alcohol (for consumption off the premises only)	Everyday 0700-2200 hours
Proposed Opening Hours	Everyday 0700-2200 hours

3.2 The Council advertised the application on our website and notice boards. Officers are satisfied the advertising regulations for this application were complied with. The application is subject to a statutory 28 day consultation period in which responsible authorities and other parties are able to make representations which are relevant to the licensing objectives which are:

- Public safety,
- The protection of children from harm,
- The prevention of crime and disorder, and
- The prevention of public nuisance

3.3 The applicant has proposed steps to promote the licensing objectives within the operating schedule of the application form, see section 18 of Appendix 1.

4 REPRESENTATIONS

- 4.1 Representations are relevant if they relate to the likely effect of the granting of the application in promotion of the licensing objectives. In other words, representations need to relate to the impact of licensable activities carried on from a premises on the licensing objectives.
- 4.2 Within the consultation period the application attracted four (4) valid representations opposing the application which related to the possibility that neighbouring residents would be affected by noise nuisance and anti-social behaviour and the possibility of youths congregating outside the premises. These have been attached at Appendix 3.
- 4.3 None of the eight (8) Responsible Authorities made representations against this application.

5 CONSIDERATION

- 5.1 A licensing authority must carry out its functions under the Licensing Act 2003 with a view to promoting the licensing objectives which are listed at para 3.2 above.
- 5.2 When determining the application, members must take the steps they consider appropriate to promote the licensing objectives.
- 5.3 Having determined the application, the licensing authority must notify its decision and its reasons for that decision to the applicant, any person who has made representation and the Chief Officer if Police in which the premises is situated.
- 5.4 An appeal against the decision made in determining this application may be made to the Magistrates Court within 21 days of all parties being notified of the local authority's decision.

6 POLICY IMPLICATIONS

- 6.1 In carrying out its licensing functions, a licensing authority must have regard to its "Statement of Licensing Policy" and the guidance issued under section 182 of the Licensing Act 2003. Relevant extracts of both documents are attached at Appendices 4 and 5.

7 EQUALITIES and HUMAN RIGHTS

- 7.1 Equalities/Human rights - Under the Human Rights Act 1998, the sub-committee needs to consider the balance between the rights of the applicant/licensee and those making representations when making their decision. The sub-committee has a duty under section 17 of the Crime and Disorder Act 1998 when making its decision to do all it can to prevent crime and disorder in the district.

- 7.2 Legal Implications - The decision made by this sub-committee is subject to appeal rights to the Magistrates Court. Appeal rights must be included within the decision notice.
- 7.3 Where a decision is made that is contrary to the statement of Licensing Policy or is contrary to statutory guidance members must clearly state their grounds for departing from those documents within the decision notice.
- 7.4 The duties to take steps appropriate to promote the licensing objectives are referred to throughout this report.

8 CONCLUSION and DETERMINATION

- 8.1 The sub-committee must consider the application on its own individual merits and take into account all relevant matters then determine the applications by taking the steps it considers appropriate to promote the licensing objectives. The options available to the committee are detailed within paragraph 2.2 of this report

Contact Details: Ms Angela Semowo Tel: 01252 622122
angela.semowo@basingstoke.gov.uk

APPENDICES / CONFIDENTIAL APPENDICES

- Appendix 1 – Liquor and Vape Store Premises Licence Application Form**
Appendix 2 – Premises Plan
Appendix 3 – Relevant representations opposing the application
Appendix 4 - Extracts from the Hart District Council Statement of Licensing Policy
Appendix 5 - Extracts from the Licensing Act 2003 section 182 Guidance

BACKGROUND PAPERS:

The Licensing Act 2003

Hart District Council – Statement of Licensing Policy

Guidance issued under section 182 of the Licensing Act 2003



* required information

Section 1 of 21

You can save the form at any time and resume it later. You do not need to be logged in when you resume.

- System reference This is the unique reference for this application generated by the system.
- Your reference You can put what you want here to help you track applications if you make lots of them. It is passed to the authority.
- Are you an agent acting on behalf of the applicant? Put "no" if you are applying on your own behalf or on behalf of a business you own or work for.
- Yes No

Applicant Details

- * First name
- * Family name
- * E-mail
- Main telephone number Include country code.
- Other telephone number
- Indicate here if the applicant would prefer not to be contacted by telephone

Is the applicant:

- Applying as a business or organisation, including as a sole trader
- Applying as an individual
- A sole trader is a business owned by one person without any special legal structure. Applying as an individual means the applicant is applying so the applicant can be employed, or for some other personal reason, such as following a hobby.

Applicant Business

- Is the applicant's business registered in the UK with Companies House? Yes No
- Registration number
- Business name If the applicant's business is registered, use its registered name.
- VAT number Put "none" if the applicant is not registered for VAT.
- Legal status

Continued from previous page...

Applicant's position in the business

Home country

The country where the applicant's headquarters are.

Registered Address

Address registered with Companies House.

Building number or name

Street

District

City or town

County or administrative area

Postcode

Country

Agent Details

* First name

* Family name

* E-mail

Main telephone number

Include country code.

Other telephone number

Indicate here if you would prefer not to be contacted by telephone

Are you:

- An agent that is a business or organisation, including a sole trader
- A private individual acting as an agent

A sole trader is a business owned by one person without any special legal structure.

Your Address

Address official correspondence should be sent to.

* Building number or name

* Street

District

* City or town

County or administrative area

* Postcode

* Country

Continued from previous page...

Section 2 of 21

PREMISES DETAILS

I/we, as named in section 1, apply for a premises licence under section 17 of the Licensing Act 2003 for the premises described in section 2 below (the premises) and I/we are making this application to you as the relevant licensing authority in accordance with section 12 of the Licensing Act 2003.

Premises Address

Are you able to provide a postal address, OS map reference or description of the premises?

- Address OS map reference Description

Postal Address Of Premises

Building number or name	<input type="text" value="Liquor & Vape Shop"/>
Street	<input type="text" value="158 Aldershot Road"/>
District	<input type="text" value="Church Crookham"/>
City or town	<input type="text" value="Fleet"/>
County or administrative area	<input type="text"/>
Postcode	<input type="text" value="GU52 8JT"/>
Country	<input type="text" value="United Kingdom"/>

Further Details

Telephone number	<input type="text"/>
Non-domestic rateable value of premises (£)	<input type="text" value="0"/>

Section 3 of 21

APPLICATION DETAILS

In what capacity are you applying for the premises licence?

- An individual or individuals
- A limited company / limited liability partnership
- A partnership (other than limited liability)
- An unincorporated association
- Other (for example a statutory corporation)
- A recognised club
- A charity
- The proprietor of an educational establishment
- A health service body
- A person who is registered under part 2 of the Care Standards Act 2000 (c14) in respect of an independent hospital in Wales
- A person who is registered under Chapter 2 of Part 1 of the Health and Social Care Act 2008 in respect of the carrying on of a regulated activity (within the meaning of that Part) in an independent hospital in England
- The chief officer of police of a police force in England and Wales

Confirm The Following

- I am carrying on or proposing to carry on a business which involves the use of the premises for licensable activities
- I am making the application pursuant to a statutory function
- I am making the application pursuant to a function discharged by virtue of Her Majesty's prerogative

Section 4 of 21

NON INDIVIDUAL APPLICANTS

Provide name and registered address of applicant in full. Where appropriate give any registered number. In the case of a partnership or other joint venture (other than a body corporate), give the name and address of each party concerned.

Non Individual Applicant's Name

Name

Details

Registered number (where applicable)

Description of applicant (for example partnership, company, unincorporated association etc)

Continued from previous page...

Private Limited Company

Address

Building number or name

Street

District

City or town

County or administrative area

Postcode

Country

Contact Details

E-mail

Telephone number

Other telephone number

* Date of birth

* Nationality

[Documents that demonstrate entitlement to work in the UK](#)

Section 5 of 21

OPERATING SCHEDULE

When do you want the premises licence to start? / /
dd mm yyyy

If you wish the licence to be valid only for a limited period, when do you want it to end / /
dd mm yyyy

Provide a general description of the premises

For example the type of premises, its general situation and layout and any other information which could be relevant to the licensing objectives. Where your application includes off-supplies of alcohol and you intend to provide a place for consumption of these off- supplies you must include a description of where the place will be and its proximity to the premises.

Off Licence, Convenience Store and Vapes

Continued from previous page...

If 5,000 or more people are expected to attend the premises at any one time, state the number expected to attend

Section 6 of 21

PROVISION OF PLAYS

[See guidance on regulated entertainment](#)

Will you be providing plays?

- Yes No

Section 7 of 21

PROVISION OF FILMS

[See guidance on regulated entertainment](#)

Will you be providing films?

- Yes No

Section 8 of 21

PROVISION OF INDOOR SPORTING EVENTS

[See guidance on regulated entertainment](#)

Will you be providing indoor sporting events?

- Yes No

Section 9 of 21

PROVISION OF BOXING OR WRESTLING ENTERTAINMENTS

[See guidance on regulated entertainment](#)

Will you be providing boxing or wrestling entertainments?

- Yes No

Section 10 of 21

PROVISION OF LIVE MUSIC

[See guidance on regulated entertainment](#)

Will you be providing live music?

- Yes No

Section 11 of 21

PROVISION OF RECORDED MUSIC

[See guidance on regulated entertainment](#)

Will you be providing recorded music?

- Yes No

Section 12 of 21

PROVISION OF PERFORMANCES OF DANCE

[See guidance on regulated entertainment](#)

Will you be providing performances of dance?

Continued from previous page...

Section 13 of 21

PROVISION OF ANYTHING OF A SIMILAR DESCRIPTION TO LIVE MUSIC, RECORDED MUSIC OR PERFORMANCES OF DANCE

[See guidance on regulated entertainment](#)

Will you be providing anything similar to live music, recorded music or performances of dance?

- Yes No

Section 14 of 21

LATE NIGHT REFRESHMENT

Will you be providing late night refreshment?

- Yes No

Section 15 of 21

SUPPLY OF ALCOHOL

Will you be selling or supplying alcohol?

- Yes No

Standard Days And Timings

MONDAY

Start

End

Start

End

Give timings in 24 hour clock.
(e.g., 16:00) and only give details for the days
of the week when you intend the premises
to be used for the activity.

TUESDAY

Start

End

Start

End

WEDNESDAY

Start

End

Start

End

THURSDAY

Start

End

Start

End

FRIDAY

Start

End

Start

End

SATURDAY

Start

End

Start

End

Continued from previous page...

SUNDAY

Start

End

Start

End

Will the sale of alcohol be for consumption:

- On the premises Off the premises Both

If the sale of alcohol is for consumption on the premises select on, if the sale of alcohol is for consumption away from the premises select off. If the sale of alcohol is for consumption on the premises and away from the premises select both.

State any seasonal variations

For example (but not exclusively) where the activity will occur on additional days during the summer months.

None

Non-standard timings. Where the premises will be used for the supply of alcohol at different times from those listed in the column on the left, list below

For example (but not exclusively), where you wish the activity to go on longer on a particular day e.g. Christmas Eve.

None

State the name and details of the individual whom you wish to specify on the licence as premises supervisor

Name

First name

Family name

Date of birth
dd mm yyyy

Continued from previous page...

Enter the contact's address

Building number or name

Street

District

City or town

County or administrative area

Postcode

Country

Personal Licence number (if known)

Issuing licensing authority (if known)

PROPOSED DESIGNATED PREMISES SUPERVISOR CONSENT

How will the consent form of the proposed designated premises supervisor be supplied to the authority?

- Electronically, by the proposed designated premises supervisor
- As an attachment to this application

Reference number for consent form (if known)

If the consent form is already submitted, ask the proposed designated premises supervisor for its 'system reference' or 'your reference'.

Section 16 of 21

ADULT ENTERTAINMENT

Highlight any adult entertainment or services, activities, or other entertainment or matters ancillary to the use of the premises that may give rise to concern in respect of children

Give information about anything intended to occur at the premises or ancillary to the use of the premises which may give rise to concern in respect of children, regardless of whether you intend children to have access to the premises, for example (but not exclusively) nudity or semi-nudity, films for restricted age groups etc gambling machines etc.

None

Section 17 of 21

HOURS PREMISES ARE OPEN TO THE PUBLIC

Standard Days And Timings

MONDAY

Start

End

Start

Give timings in 24 hour clock. (e.g., 16:00) and only give details for the days of the week when you intend the premises to be used for the activity.

Continued from previous page...

TUESDAY

Start	<input type="text" value="07:00"/>	End	<input type="text" value="22:00"/>
Start	<input type="text"/>	End	<input type="text"/>

WEDNESDAY

Start	<input type="text" value="07:00"/>	End	<input type="text" value="22:00"/>
Start	<input type="text"/>	End	<input type="text"/>

THURSDAY

Start	<input type="text" value="07:00"/>	End	<input type="text" value="22:00"/>
Start	<input type="text"/>	End	<input type="text"/>

FRIDAY

Start	<input type="text" value="07:00"/>	End	<input type="text" value="22:00"/>
Start	<input type="text"/>	End	<input type="text"/>

SATURDAY

Start	<input type="text" value="07:00"/>	End	<input type="text" value="22:00"/>
Start	<input type="text"/>	End	<input type="text"/>

SUNDAY

Start	<input type="text" value="07:00"/>	End	<input type="text" value="22:00"/>
Start	<input type="text"/>	End	<input type="text"/>

State any seasonal variations

For example (but not exclusively) where the activity will occur on additional days during the summer months.

None

Non standard timings. Where you intend to use the premises to be open to the members and guests at different times from those listed in the column on the left, list below

For example (but not exclusively), where you wish the activity to go on longer on a particular day e.g. Christmas Eve.

None

Section 18 of 21

LICENSING OBJECTIVES

Describe the steps you intend to take to promote the four licensing objectives:

a) General – all four licensing objectives (b,c,d,e)

Continued from previous page...

List here steps you will take to promote all four licensing objectives together.

1. Strict implementation of challenge 25 policy
2. CCTV to be installed and 31 days recording system
3. All staff to be trained in responsible alcohol retailing

b) The prevention of crime and disorder

1. CCTV shall be installed to Home Office Guidance standards and maintained in a good working condition and recordings shall be kept for 31 days and shall be made available to police and authorised Officers from the council.
2. The CCTV system shall be capable of obtaining clear facial recognition images and a clear head and shoulders image of every person entering or leaving the premises.
3. The CCTV system shall display on any recordings, the correct date and time of the recording.
4. A member of staff trained in the use of the CCTV system shall be available at the premise at all times that the premises are open to the public.
5. A CCTV camera shall be installed to cover the entrance of the premises and further cameras installed to cover the internal area and servery counter.
6. A suitable intruder alarm complete with panic button shall be fitted and maintained.
7. An incident log shall be kept at the premises, and made available for inspection on request to an authorised officer of the council or the Police, which will record the following:
 - (a) all crimes reported to the venue
 - (b) all ejections of patrons
 - (c) any complaints received
 - (d) any incidents of disorder
 - (e) all seizures of drugs or offensive weapons
 - (f) any faults in the CCTV system
 - (g) any refusal of the sale of alcohol
 - (h) any visit by a relevant authority or emergency service.
8. Staff training must be documented and based on legislation and operating procedures. All training shall be signed and dated, and a copy of such records will be available for inspection by Police and local authority enforcement officers.
9. All staff employed at the premises will have UK right to work status checked, once passed that stage they shall be offered employment.

c) Public safety

1. Installation of appropriate safety equipment
2. Fire exit signs displayed
3. CCTV working at all times

d) The prevention of public nuisance

1. Notice displayed asking customers to leave quietly from premises also customers will be told in person to leave quietly and not to disturb the local neighbourhood
2. Strict policy in place to tell all staff not to serve alcohol to drunks at all

Continued from previous page...

3. Appropriate signage will be displayed, in prominent position informing customers they are being recorded on CCTV

e) The protection of children from harm

1. A challenge 25 policy will be in force, where any person looking under the age of 25 shall be asked to prove their age when attempting to purchase alcohol and signs to this effect will be displayed at the premises. Challenge 25 posters displayed where alcohol is sold.

2. The only acceptable ID will be those with photographic identification documents, including passport, photo-card, driving license or proof of age card bearing the PASS hologram.

3. An refusal book shall be kept at the premises and updated as and when required, and made available for inspection on request to an Licensing Officer, Police or other responsible authority.

4. A sign stating "No proof of age – No sale" shall be displayed at the point of sale.

Section 19 of 21

NOTES ON DEMONSTRATING ENTITLEMENT TO WORK IN THE UK

Continued from previous page...

Entitlement to work/immigration status for individual applicants and applications from partnerships which are not limited liability partnerships:

A licence may not be held by an individual or an individual in a partnership who is resident in the UK who:

- does not have the right to live and work in the UK; or
- is subject to a condition preventing him or her from doing work relating to the carrying on of a licensable activity.

Any premises licence issued in respect of an application made on or after 6 April 2017 will become invalid if the holder ceases to be entitled to work in the UK.

Applicants must demonstrate that they have an entitlement to work in the UK and are not subject to a condition preventing them from doing work relating to the carrying on of a licensable activity. They do this in one of two ways: 1) by providing with this application copies or scanned copies of the documents listed below (which do not need to be certified), or 2) by providing their 'share code' to enable the licensing authority to carry out a check using the Home Office online right to work checking service (see below).

Documents which demonstrate entitlement to work in the UK

- An expired or current passport showing the holder, or a person named in the passport as the child of the holder, is a British citizen or a citizen of the UK and Colonies having the right of abode in the UK [please see note below about which sections of the passport to copy].
- An expired or current passport or national identity card showing the holder, or a person named in the passport as the child of the holder, is a national of a European Economic Area country or Switzerland.
- A Registration Certificate or document certifying permanent residence issued by the Home Office to a national of a European Economic Area country or Switzerland.
- A Permanent Residence Card issued by the Home Office to the family member of a national of a European Economic Area country or Switzerland.
- A **current** Biometric Immigration Document (Biometric Residence Permit) issued by the Home Office to the holder indicating that the person named is allowed to stay indefinitely in the UK, or has no time limit on their stay in the UK.
- A **current** passport endorsed to show that the holder is exempt from immigration control, is allowed to stay indefinitely in the UK, has the right of abode in the UK, or has no time limit on their stay in the UK.
- A **current** Immigration Status Document issued by the Home Office to the holder with an endorsement indicating that the named person is allowed to stay indefinitely in the UK or has no time limit on their stay in the UK, **when produced in combination with** an official document giving the person's permanent National Insurance number and their name issued by a Government agency or a previous employer.
- A birth or adoption certificate issued in the UK, **when produced in combination with** an official document giving the person's permanent National Insurance number and their name issued by a Government agency or a previous employer.
- A birth or adoption certificate issued in the Channel Islands, the Isle of Man or Ireland **when produced in combination with** an official document giving the person's permanent National Insurance number and their name issued by a Government agency or a previous employer.
- A certificate of registration or naturalisation as a British citizen, **when produced in combination with** an official document giving the person's permanent National Insurance number and their name issued by a Government agency or a previous employer.

Continued from previous page...

- A **current** passport endorsed to show that the holder is allowed to stay in the UK and is currently allowed to work and is not subject to a condition preventing the holder from doing work relating to the carrying on of a licensable activity.
- A **current** Biometric Immigration Document (Biometric Residence Permit) issued by the Home Office to the holder which indicates that the named person can currently stay in the UK and is allowed to work relation to the carrying on of a licensable activity.
- A **current** Residence Card issued by the Home Office to a person who is not a national of a European Economic Area state or Switzerland but who is a family member of such a national or who has derivative rights or residence.
- A **current** Immigration Status Document containing a photograph issued by the Home Office to the holder with an endorsement indicating that the named person may stay in the UK, and is allowed to work and is not subject to a condition preventing the holder from doing work relating to the carrying on of a licensable activity **when produced in combination with** an official document giving the person's permanent National Insurance number and their name issued by a Government agency or a previous employer.
- A Certificate of Application, **less than 6 months old**, issued by the Home Office under regulation 18(3) or 20(2) of the Immigration (European Economic Area) Regulations 2016, to a person who is not a national of a European Economic Area state or Switzerland but who is a family member of such a national or who has derivative rights of residence.
- Reasonable evidence that the person has an outstanding application to vary their permission to be in the UK with the Home Office such as the Home Office acknowledgement letter or proof of postage evidence, or reasonable evidence that the person has an appeal or administrative review pending on an immigration decision, such as an appeal or administrative review reference number.
- Reasonable evidence that a person who is not a national of a European Economic Area state or Switzerland but who is a family member of such a national or who has derivative rights of residence in exercising treaty rights in the UK including:-
 - evidence of the applicant's own identity – such as a passport,
 - evidence of their relationship with the European Economic Area family member – e.g. a marriage certificate, civil partnership certificate or birth certificate, and
 - evidence that the European Economic Area national has a right of permanent residence in the UK or is one of the following if they have been in the UK for more than 3 months:
 - (i) working e.g. employment contract, wage slips, letter from the employer,
 - (ii) self-employed e.g. contracts, invoices, or audited accounts with a bank,
 - (iii) studying e.g. letter from the school, college or university and evidence of sufficient funds; or
 - (iv) self-sufficient e.g. bank statements.

Family members of European Economic Area nationals who are studying or financially independent must also provide evidence that the European Economic Area national and any family members hold comprehensive sickness insurance in the UK. This can include a private medical insurance policy, an EHIC card or an S1, S2 or S3 form.

Original documents must not be sent to licensing authorities. If the document copied is a passport, a copy of the following pages should be provided:-

- (i) any page containing the holder's personal details including nationality;
- (ii) any page containing the holder's photograph;
- (iii) any page containing the holder's signature;
- (iv) any page containing the date of expiry; and
- (v) any page containing information indicating the holder has permission to enter or remain in the UK and is permitted to work.

Continued from previous page...

If the document is not a passport, a copy of the whole document should be provided.

Your right to work will be checked as part of your licensing application and this could involve us checking your immigration status with the Home Office. We may otherwise share information with the Home Office. Your licence application will not be determined until you have complied with this guidance.

Home Office online right to work checking service

As an alternative to providing a copy of the documents listed above, applicants may demonstrate their right to work by allowing the licensing authority to carry out a check with the Home Office online right to work checking service.

To demonstrate their right to work via the Home Office online right to work checking service, applicants should include in this application their 9-digit share code (provided to them upon accessing the service at <https://www.gov.uk/prove-right-to-work>) which, along with the applicant's date of birth (provided within this application), will allow the licensing authority to carry out the check.

In order to establish the applicant's right to work, the check will need to indicate that the applicant is allowed to work in the United Kingdom and is not subject to a condition preventing them from doing work relating to the carrying on of a licensable activity.

An online check will not be possible in all circumstances because not all applicants will have an immigration status that can be checked online. The Home Office online right to work checking service sets out what information and/or documentation applicants will need in order to access the service. Applicants who are unable to obtain a share code from the service should submit copy documents as set out above.

Section 20 of 21

NOTES ON REGULATED ENTERTAINMENT

Continued from previous page...

In terms of specific **regulated entertainments** please note that:

- Plays: no licence is required for performances between 08:00 and 23.00 on any day, provided that the audience does not exceed 500.
- Films: no licence is required for 'not-for-profit' film exhibition held in community premises between 08.00 and 23.00 on any day provided that the audience does not exceed 500 and the organiser (a) gets consent to the screening from a person who is responsible for the premises; and (b) ensures that each such screening abides by age classification ratings.
- Indoor sporting events: no licence is required for performances between 08.00 and 23.00 on any day, provided that the audience does not exceed 1000.
- Boxing or Wrestling Entertainment: no licence is required for a contest, exhibition or display of Greco-Roman wrestling, or freestyle wrestling between 08.00 and 23.00 on any day, provided that the audience does not exceed 1000. Combined fighting sports – defined as a contest, exhibition or display which combines boxing or wrestling with one or more martial arts – are licensable as a boxing or wrestling entertainment rather than an indoor sporting event.
- Live music: no licence permission is required for:
 - o a performance of unamplified live music between 08.00 and 23.00 on any day, on any premises.
 - o a performance of amplified live music between 08.00 and 23.00 on any day on premises authorised to sell alcohol for consumption on those premises, provided that the audience does not exceed 500.
 - o a performance of amplified live music between 08.00 and 23.00 on any day, in a workplace that is not licensed to sell alcohol on those premises, provided that the audience does not exceed 500.
 - o a performance of amplified live music between 08.00 and 23.00 on any day, in a church hall, village hall, community hall, or other similar community premises, that is not licensed by a premises licence to sell alcohol, provided that (a) the audience does not exceed 500, and (b) the organiser gets consent for the performance from a person who is responsible for the premises.
 - o a performance of amplified live music between 08.00 and 23.00 on any day, at the non-residential premises of (i) a local authority, or (ii) a school, or (iii) a hospital, provided that (a) the audience does not exceed 500, and (b) the organiser gets consent for the performance on the relevant premises from: (i) the local authority concerned, or (ii) the school or (iii) the health care provider for the hospital.
- Recorded Music: no licence permission is required for:
 - o any playing of recorded music between 08.00 and 23.00 on any day on premises authorised to sell alcohol for consumption on those premises, provided that the audience does not exceed 500.
 - o any playing of recorded music between 08.00 and 23.00 on any day, in a church hall, village hall, community hall, or other similar community premises, that is not licensed by a premises licence to sell alcohol, provided that (a) the audience does not exceed 500, and (b) the organiser gets consent for the performance from a person who is responsible for the premises.
 - o any playing of recorded music between 08.00 and 23.00 on any day, at the non-residential premises of (i) a local authority, or (ii) a school, or (iii) a hospital, provided that (a) the audience does not exceed 500, and (b) the organiser gets consent for the performance on the relevant premises from: (i) the local authority concerned, or (ii) the school proprietor or (iii) the health care provider for the hospital.

Continued from previous page...

- Dance: no licence is required for performances between 08.00 and 23.00 on any day, provided that the audience does not exceed 500. However, a performance which amounts to adult entertainment remains licensable.
- Cross activity exemptions: no licence is required between 08.00 and 23.00 on any day, with no limit on audience size for:
 - o any entertainment taking place on the premises of the local authority where the entertainment is provided by or on behalf of the local authority;
 - o any entertainment taking place on the hospital premises of the health care provider where the entertainment is provided by or on behalf of the health care provider;
 - o any entertainment taking place on the premises of the school where the entertainment is provided by or on behalf of the school proprietor; and
 - o any entertainment (excluding films and a boxing or wrestling entertainment) taking place at a travelling circus, provided that (a) it takes place within a moveable structure that accommodates the audience, and (b) that the travelling circus has not been located on the same site for more than 28 consecutive days.

Section 21 of 21

PAYMENT DETAILS

This fee must be paid to the authority. If you complete the application online, you must pay it by debit or credit card.

Premises Licence Fees are determined by the non-domestic rateable value of the premises.

To find out a premises non domestic rateable value go to the Valuation Office Agency site at http://www.voa.gov.uk/business_rates/index.htm

Band A - No RV to £4300 £100.00

Band B - £4301 to £33000 £190.00

Band C - £33001 to £8700 £315.00

Band D - £87001 to £12500 £450.00*

Band E - £125001 and over £635.00*

*If the premises rateable value is in Bands D or E and the premises is primarily used for the consumption of alcohol on the premises then your are required to pay a higher fee

Band D - £87001 to £12500 £900.00

Band E - £125001 and over £1,905.00

There is an exemption from the payment of fees in relation to the provision of regulated entertainment at church halls, chapel halls or premises of a similar nature, village halls, parish or community halls, or other premises of a similar nature. The costs associated with these licences will be met by central Government. If, however, the licence also authorises the use of the premises for the supply of alcohol or the provision of late night refreshment, a fee will be required.

Schools and sixth form colleges are exempt from the fees associated with the authorisation of regulated entertainment where the entertainment is provided by and at the school or college and for the purposes of the school or college.

If you operate a large event you are subject to ADDITIONAL fees based upon the number in attendance at any one time

Capacity 5000-9999 £1,000.00

Capacity 10000 -14999 £2,000.00

Capacity 15000-19999 £4,000.00

Capacity 20000-29999 £8,000.00

Capacity 30000-39000 £16,000.00

Capacity 40000-49999 £24,000.00

Capacity 50000-59999 £32,000.00

Capacity 60000-69999 £40,000.00

Capacity 70000-79999 £48,000.00

Capacity 80000-89999 £56,000.00

Capacity 90000 and over £64,000.00

* Fee amount (£)

100.00

DECLARATION

Continued from previous page...

[Applicable to individual applicants only, including those in a partnership which is not a limited liability partnership] I understand I am not entitled to be issued with a licence if I do not have the entitlement to live and work in the UK (or if I am subject to a condition preventing me from doing work relating to the carrying on of a licensable activity) and that my licence will become invalid if I cease to be entitled to live and work in the UK (please read guidance note 15).

The DPS named in this application form is entitled to work in the UK (and is not subject to conditions preventing him or her from doing work relating to a licensable activity) and I have seen a copy of his or her proof of entitlement to work, if appropriate (please see note 15).

I/we understand it is an offence, liable on conviction to a fine up to level 5 on the standard scale, under section 158 of the licensing act 2003, to make a false statement in or in connection with this application.

I understand that I must now advertise my application in a locally circulating newspaper (or if there is none, in a local newsletter, circular or similar document) circulating in the vicinity of the premises, at least once during the 10 working days after the application is given to the relevant licensing authority.

I understand that I must display a public notice outside the premises for 28 consecutive days, on pale blue A4 (or larger), printed legibly in black ink or typed in black, in a size equal (or larger) to 16 font, prominently at or on the premises to which the application relates. Where the premises covers an area of more than 50 metre squared, the same notice must be placed every 50 metres along the external perimeter of the premises.

Ticking this box indicates you have read and understood the above declaration

This section should be completed by the applicant, unless you answered "Yes" to the question "Are you an agent acting on behalf of the applicant?"

* Full name

* Capacity

* Date / /
dd mm yyyy

Once you're finished you need to do the following:

1. Save this form to your computer by clicking file/save as...
2. Go back to <https://www.gov.uk/apply-for-a-licence/premises-licence/hart/apply-1> to upload this file and continue with your application.

Don't forget to make sure you have all your supporting documentation to hand.

IT IS AN OFFENCE LIABLE TO SUMMARY CONVICTION TO A FINE OF ANY AMOUNT UNDER SECTION 158 OF THE LICENSING ACT 2003, TO MAKE A FALSE STATEMENT IN OR IN CONNECTION WITH THIS APPLICATION

IT IS AN OFFENCE UNDER SECTION 24B OF THE IMMIGRATION ACT 1971 FOR A PERSON TO WORK WHEN THEY KNOW, OR HAVE REASONABLE CAUSE TO BELIEVE, THAT THEY ARE DISQUALIFIED FROM DOING SO BY REASON OF THEIR IMMIGRATION STATUS. THOSE WHO EMPLOY AN ADULT WITHOUT LEAVE OR WHO IS SUBJECT TO CONDITIONS AS TO EMPLOYMENT WILL BE LIABLE TO A CIVIL PENALTY UNDER SECTION 15 OF THE IMMIGRATION, ASYLUM AND NATIONALITY ACT 2006 AND PURSUANT TO SECTION 21 OF THE SAME ACT, WILL BE COMMITTING AN OFFENCE WHERE THEY DO SO IN THE KNOWLEDGE, OR WITH REASONABLE CAUSE TO BELIEVE, THAT THE EMPLOYEE IS DISQUALIFIED

OFFICE USE ONLY

Applicant reference number	<input type="text"/>
Fee paid	<input type="text"/>
Payment provider reference	<input type="text"/>
ELMS Payment Reference	<input type="text"/>
Payment status	<input type="text"/>
Payment authorisation code	<input type="text"/>
Payment authorisation date	<input type="text"/>
Date and time submitted	<input type="text"/>
Approval deadline	<input type="text"/>
Error message	<input type="text"/>
Is Digitally signed	<input type="checkbox"/>

[1](#) [2](#) [3](#) [4](#) [5](#) [6](#) [7](#) [8](#) [9](#) [10](#) [11](#) [12](#) [13](#) [14](#) [15](#) [16](#) [17](#) [18](#) [19](#) [20](#) [21](#) [Next >](#)

PROPOSED LICENSING FLOOR PLAN

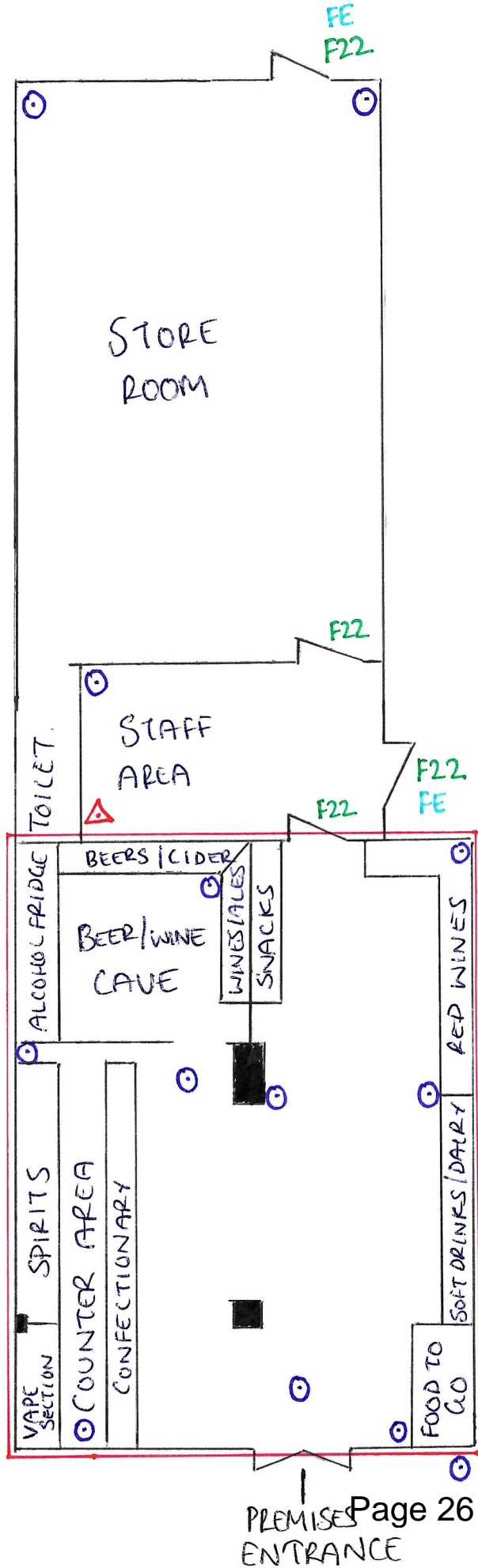

PREMISES DETAILS:
 LIQUOR & VAPE SHOP
 158 ALDERSHOT ROAD
 CHURCH CROOKHAM
 FLEET.
 GU52 8JT.

KEY:
 LICENSABLE ACTIVITY AREA
 ○ CCTV
 F22 FIRE EXIT SIGN
 FE FIRE EXIT.
 ▲ FIRE EXTINGUISHER.
 SCALE: 1:100

From: [REDACTED]
Sent: Sunday, May 7, 2023 9:51:37 PM (UTC+00:00) Monrovia, Reykjavik
To: Hartlicensing <hartlicensing@basingstoke.gov.uk>
Subject: Objection to Licence application at 158 Aldershot Road

**** PLEASE NOTE: This message has originated from a source external to Basingstoke & Deane Borough Council, and has been scanned for viruses. Basingstoke and Deane Borough Council reserves the right to store and monitor e-mails ****

I would like to formally object to the licence application for Liquor and Vapes store at 158 Aldershot Road, Church Crookham GU52 8JT. 22/00228/LAPRE

[REDACTED]. I was not informed of this application by either the owners of the shop or by the council. As this directly affects me I should have been written to and notified of this application, all my neighbours seem to have been informed, yet I was left off the list.

The Prevention of Crime and Disorder

Alcohol is already known to cause an increase in antisocial behaviour, I am concerned this will become a problem with people close to the vicinity. There is already an issue with groups of people in Azalea Park causing issues with anti social behaviour which will only increase with alcohol and vapes being more readily available. Granting a licence would provide a further source of alcohol within an area already so heavily populated with licensed premises that crime, disorder and public nuisance will become a greater problem

The Prevention of Public Nuisance

This is a primarily residential area with a residential property directly above the shop.

Noise - although there been some improvements to the sound proofing [REDACTED]

[REDACTED] and customers coming in and out constantly.

Hours - The proposed hours are 7am to 10pm 7 days a week. This is massively increased from the hours the shop previously opened when it was an off licence over 13 years ago. Wine shack was open 10am to 8pm sometimes 6pm.

The other shops directly in the vicinity of this one have significantly shorter hours than this, and are closed at least one day a week. The pharmacy opposite is 9-6 Monday to Friday with a half day on a Saturday. Ho's takeaway is 12-1.30 and 5-9 or 9-30 on Friday and Saturday evenings. Both are closed on Sundays and both have residential properties above them.

If this is approved with the proposed current hours I will have no quality of life in my own home as there will be staff in the shop before 7am and after 10pm to prepare to open and close the shop. The noise and intrusion will be intolerable, I have been woken up by the builders arriving to do work in the shop at 7.30am for the last two months, if this starts from 6.30 or 7am every day the lack of sleep will have a profound affect on my mental and physical health.

[REDACTED] that are open from 6 or 7 am to at least 9 or 10pm selling groceries as well as alcohol and vapes. There is

no need or demand for a shop of this type to be open for these hours when it will directly affect the residents living next to the shop and above it.

Public Safety

Parking - there is very minimal parking at the front of the property, only one car would be able to park at a time, you are able to get two small cars but only if you parallel park from the main road which is extremely busy making this quite dangerous.

I have been using this parking for the last 15 years I have lived here, although this is not included in my lease it has always been allowed. When the previous planning applications were submitted for residential flats instead of the shop it was established that parking would need to be provided for my flat for any future developments.

Parking has been significantly reduced in the side streets around Aldershot Road that would have provided alternative parking for me or customers to the shop. Haig lane has half the available parking as this was made double yellow lines.

Rounton road also has reduced parking due the pharmacy opening and taking additional road spaces away for their customer parking. I am unable to park on the main road in front of my flat due to the congestion this would cause. Traffic is already backed up past Rounton road most mornings parking on the road by either myself or customers to the shop would cause even more congestion.

There is already significant strain on the parking due to the chip shop Chinese take away and the pharmacy, this shop is only going to add to this. There are frequent accidents due to congestion or standing traffic making it difficult to see and pull out of side roads.

With delivery lorries also unable to potentially park off road it will cause increased congestion to the already busy road if they have to park into the road.

Please consider the impact this will have on traffic, noise and disruption to the residents.

Kind regards

██████████
██████████████████
██████████████████
██████████

Sent from [Mail](#) for Windows

From: [REDACTED]
Sent: Thursday, May 11, 2023 11:01:15 AM (UTC+00:00) Monrovia, Reykjavik
To: Hartlicensing <hartlicensing@basingstoke.gov.uk>
Cc: [REDACTED]
Subject: Objection to Licence application 23/00228/LAPRE at 158 Aldershot Road, Church Crookham

**** PLEASE NOTE: This message has originated from a source external to Basingstoke & Deane Borough Council, and has been scanned for viruses. Basingstoke and Deane Borough Council reserves the right to store and monitor e-mails ****

Dear Ms Angela Semowo,

Background

I am writing to raise a specific objection to the pending Licence Application 23/00228/LAPRE for 158 Aldershot Road, Church Crookham.

[REDACTED]

The shop, with flat above, has residential properties to either side and on the opposite side of the road. Many of these properties have school aged children living there.

[REDACTED] there was a Wine Rack Off Licence operating from the shop.

That was open over hours that largely mirrored that of the current Majestic Off Licence Store on Fleet High Street, (that also has residential property above it) :

Monday to Wednesday 1000-1900

Thursday to Friday 1000 - 2000

Saturday 0900 - 1900

Sunday 1000 - 1700

Those hours were found to be acceptable as they did not compromise the sleep patterns and quality of life of the occupants of the flat above the shop.

Specific Objection

I do not in principle object to the idea of having an Off Licence shop at 158 Aldershot Road.

However, I raise this objection on the grounds of 'Noise' under the Licencing Objective 'The Prevention of Public Nuisance' and possibly other Objectives.

The Application seeks Opening hours of 0700-2200 every day. With pre opening preparation and post closing finishing up the Noisy time could easily be extended by 30 minutes either side of the 0700-2200 period.

There also exists the possibility of deliveries outside of the opening hours that could generate additional adverse noise.

That could leave only 8 hours per day without the associated noise from a working shop [REDACTED]
[REDACTED]

Conclusion

As stated above I do not object to the Application in general but do object to the proposed Opening Hours.

I would urge the Licencing Sub Committee to consider:

Adjusting the Opening Hours to reduce Noise for the occupants of the flat above the shop and the surrounding neighbours, many with young children.

Making a condition of the Licence that deliveries should occur only during the agreed Opening Hours.

Yours Sincerely

[REDACTED]

[REDACTED]

[REDACTED]

[REDACTED]

[REDACTED]

[REDACTED]

From: [REDACTED]
Sent: Thursday, May 11, 2023 3:04:45 PM (UTC+00:00) Monrovia, Reykjavik
To: LicensingComplaints <licensingcomplaints@basingstoke.gov.uk>
Subject: Re: 22/00228/LAPRE - PREMISES LICENCE APPLICATION - LIQUOR and VAPE STORE, 158 ALDERSHOT ROAD, CHURCH CROOKHAM, FLEET

**** PLEASE NOTE: This message has originated from a source external to Basingstoke & Deane Borough Council, and has been scanned for viruses. Basingstoke and Deane Borough Council reserves the right to store and monitor e-mails ****

Good afternoon,

In relation to your previous email

Public Safety. The ongoing parking issues are causing antisocial driving due to the lack of capacity of the already busy Hos fish bar. Cars block the pavement causing pedestrians issues and preventing wheel chairs from passing safely. Another shop will only increase this.

The Prevention of Public Nuisance. No one wants these shops. None of my neighbours want them. The new housing estates built over recent years have massively increased traffic flow on a narrow road. The constant hooting of horns as people queue to get passed parked cars is a huge nuisance. This shop will only compound matters. Despite the proprietors best intentions, their shop will no doubt supply youths intentionally or not with alcohol. Youths will congregate outside the shop and it will lead to antisocial behaviour. Why can't they sell something healthy that will boost the health of the local community. They want to sell vapes and alcohol which can only be negative.

The Protection of Children from Harm. I don't want my children to grow up opposite an off licence and a vape shop. They will be mentally bombarded daily with images advertising these products which is bound to have a long term impact on them.

Please reject this proposal and ask the owner to sell something that will have a positive impact on the community.

From: [REDACTED]
Sent: Wednesday, May 10, 2023 5:57:41 PM (UTC+00:00) Monrovia, Reykjavik
To: Hartlicensing <hartlicensing@basingstoke.gov.uk>
Subject: 22/00228/LAPRE

**** PLEASE NOTE: This message has originated from a source external to Basingstoke & Deane Borough Council, and has been scanned for viruses. Basingstoke and Deane Borough Council reserves the right to store and monitor e-mails ****

To whom it may concern,

In relation to the above application ref 22/00228/LAPRE

I strongly object to this application. Much for the same reasons I objected to the conversion of 164 Aldershot Road at the beginning of this year ref planning application 22/02802/FUL.

I would also point out that my neighbour at 165 Aldershot Road had not received a copy of your leaflet. They live directly opposite the proposed property and would be one of the most affected properties. Can you be sure you have properly given all residents the opportunity to object to this application. I would suggest not.

Below are my comments in relation to the application 22/02802/FUL which mirror much of my concerns over the application in question 22/00228/LAPRE. I would also invite you to revisit all the objections raised by the residents in application 22/02802/FUL.

Insufficient traffic capacity

Insufficient Parking.

Additional Littering

Antisocial behaviour

Not supported by the local school

Unhealthy lifestyle

Antisocial driving

Unnecessary business.

Unwanted type of business

Damage to the nearby trees.

Risks to wildlife.

Wasted public funds

Noise Pollution

Traffic pollution.

I don't see what positivity this business brings to the local community. Vapes can be purchased from Tesco Express 0.1 miles away, from Co-Op 0.4 miles away, or online. Clearly none of the local residents support the application which suggests the business might be better placed elsewhere closer to a community who actually want a vape shop. A shop of this type is more suited to a town centre. I have a young family and do not want my children growing up opposite something which will have a negative influence on them to take up an unhealthy daily habit every time they leave their front door. Not to mention all the local children from primary and senior schools that will pass this shop daily on their way to/from school. There is already significant traffic congestion in the area due to all the new housing causing tail backs from the Tesco roundabout along Aldershot Road and beyond Rounton Road. Not to mention the other roads from the same roundabout. The parking outside the already very busy chip shop causes drivers to accelerate hard past the woeful parking with wing mirrors of parked or moving cars sent skittling along the road regularly. Drivers often beep at each other throughout busy periods on a daily basis, presumably frustrated at whose turn it is to negotiate the badly parked cars. The antisocial aspect of this is already unacceptable, a noise nuisance and causes increased pollution due to stationary traffic. Customers attending the shop will only exacerbate this further, despite the plan for a car park (most customers will likely just park out the front.) Speaking of which, the proposed car park appears to be an ill thought out solution due to the effects on wildlife and neighbours. The current building work within the shop has left all the building materials just dumped on the pavement. This is unsightly, unsafe and a health hazard. I have no confidence in the proprietor to ensure their contractors keep a tidy, safe or healthy building site and clearly have a lack of regard for the local community. They have either attended and seen the mess and done nothing significant to remedy the situation, or not bothered to visit. Either way it is not a good look for them. Again, I fail to see any benefit that this shop, or the proposed extension will offer the local community. I feel the council should have consulted the local community about the nature of the business before moving this far forward. The shop is not a well received addition to the community and is likely to cause the council and the police a long list of complaints about the topics listed above. This in turn will have a significant financial impact on both these public resources' budgets which are already stretched post pandemic. This money would be better spent on projects supported by the local community not opposed by the local community.

I enclose a photo to show the current state of parking during the opening times of the chip shop Ho's fish Bar.

As you can see the side streets are filled up and there is parking the full length of the pavement and the grass verge, parking on double yellow lines on Haig Lane plus wear on the grass verge when it is even busier. This image was taken on Saturday 15th April this year.

When vehicles are parked like this it causes antisocial driving, noise pollution and air pollution due to the queue of vehicles that builds up behind the parked cars waiting for oncoming traffic. Frustrated

queueing vehicles then take risks accelerating hard to try and get past the parked cars when there is a gap in oncoming traffic. The results in high engine noise, tire squealing and horn blaring from oncoming vehicles, put at risk by the anti-social driving.

I appreciate that this property was once an off licence called the Wine Shack.

The Wine shack was a different business to that proposed in that it sold wines and ales from the medium price range which would not attract younger/underage customers with a more limited budget.

As stated above. There are vapes and alcohol available from Co-op and Tesco express. Previous similar businesses have failed such as Byrne Brothers on Beacon Hill road and the Wine Shack itself. This mainly due to the branded and more popular Tesco and Co-op. The only gap in the market that this shop can fill is that which will better accommodate underage drinking in order to survive.

Based on the associated application there is strong opposition to this shop from the local community and with good reason. It is only going to cause discontent with its neighbours in an already overcrowded area.

Also parking outside the property is reserved for those who live in the flats above.

This shop simply isn't wanted, it will cause many problems and is unnecessary based on other established shops within walking distance.

Regards,

[REDACTED]

From: [REDACTED]
Sent: Thursday, May 11, 2023 7:41:40 PM (UTC+00:00) Monrovia, Reykjavik
To: Hartlicensing <hartlicensing@basingstoke.gov.uk>
Subject: 22/00228/LAPRE 158 Aldershot Road - Objection

**** PLEASE NOTE: This message has originated from a source external to Basingstoke & Deane Borough Council, and has been scanned for viruses. Basingstoke and Deane Borough Council reserves the right to store and monitor e-mails ****

To whom it may concern

As a local resident that lives in close proximity to 158 Aldershot Road I am writing to object to this application for a number of reasons.

This area of Aldershot Road is already overwhelmed with traffic and the availability of safe parking spaces is an issue. We are already witnessing on a daily basis congested traffic and potential collisions where cars are parked inappropriately on the road whilst visiting the local pharmacy and Ho's Fish and Chip takeaway. We are also witnessing the side roads of Rounton Road and Haig Lane becoming ever more populated due to there not being enough allocated parking spaces for the premises already mentioned.

The sale of alcohol from 0700 until 2200 is a concern for anti-social behaviour reasons and in our personal experiences will lead to the congregating of groups gathering. CCTV is not a good enough deterrent and will potentially lead to increased demand for local Police/Community Officers to attend and disperse. This road is used by children making their way to school and advertising the sale of alcohol and vapes from 0700 is not the kind of local business we are willing to support.

We do not see there is a requirement for a premises like this in this area of Church Crookham as we have local amenities either side of Aldershot Road which both sell alcohol between appropriate hours along with other essential needs (Tesco Express and The Co-Op) and we understand a Vape shop business (Medusa Vape) has already been permitted planning and is due to open shortly at 164 Aldershot Road. This enhances both statements made above ref parking and anti-social behaviour and strengthens the concern that there is no requirement for an additional business of this nature locally.

Please let me know if you require any further information.

Many thanks

[REDACTED]

APPENDIX 4

2 BACKGROUND

2.1 When administering licensing matters the council as the Licensing Authorities will have regard to and promote the four Licensing Objectives set out in section 4 of Part 2 of the Licensing Act 2003. The four licensing objectives are: • Prevention of Crime and Disorder • Public Safety • Prevention of Public Nuisance, and • Protection of Children from Harm The Council gives equal weight to each of these objectives. 2.2 The 2003 Act requires Licensing Authorities to publish a 'Statement of Licensing Policy' (the Policy) that sets out the approach the Licensing Authorities will take when administering applications and other processes under the Licensing Act 2003 to ensure the promotion of the licensing objectives.

3 SCOPE

3.1 Licensing authorities regulate the Licensing Act 2003 ('the Act') and are responsible for considering a range of licence applications and amendments to licences for a number of activities detailed below. Basingstoke and Deane Borough and Hart District Councils are licensing authorities for the purposes of the Act. This 'Statement of Licensing' ('policy') covers the areas of Basingstoke and Deane Borough Council and Hart District Councils ('the councils'). The Act requires the councils to produce a statement of principles concerning their duties under the Act every five years. The purpose of licensing is to regulate the carrying on of licensable activities on licensed premises, at qualifying clubs and under temporary event notices. The activities as defined by the Act include:

- Sale and/or supply of alcohol

3.2 The types of premises likely to be included within the licensing regime include:

- Off licences (includes supermarkets/shops selling alcohol)

3.3 The Policy will apply across a range of applications which include the following:

- New Premises Licences and Club Premises Certificates

4 LINKS TO OTHER COUNCIL STRATEGIES AND PROJECTS

Hart is a small but very strongly performing economy in the northeast corner of Hampshire. It borders Berkshire to the north and Surrey to the south-east. Two of the largest settlements, Fleet and Yateley, lie towards the east of the Areas covered by this policy. The remainder of the areas covered by this policy is largely rural with 16 parishes and a number of lively smaller rural settlements.

The area has good communication links with London, Heathrow and Gatwick Airports and the rest of southern England and is close to the Farnborough and Aldershot conurbation. The M3 motorway and main London to Southampton railway both pass through the Areas covered by this policy. The M4 motorway is some 12 miles to the north of Fleet, and the M25 is some 15 miles to the east. The highly attractive rural character of the Areas covered by this policy and good communication links are key factors that help to make it an attractive area for commercial and residential development.

5 POLICY AIMS

5.1 This Policy aims to promote the Licensing Authority's vision for the areas covered as a whole and its hopes: 'to encourage in the areas covered by this policy a wide choice of high quality and responsibly managed entertainment and cultural venues which provide a diverse range of licensed activities, community interaction and a variety of places for retail and refreshment; ensuring at all times the safety and amenity of residential communities, business communities and the visiting public'

5.3 In Hart the largest concentration of the population is in Fleet including Church Crookham, which had a population of 37,760 in 2011 (Office of National Statistics). The other larger settlements are not on the same scale as Fleet with Church Crookham, with populations of 14,829 in Yateley, 10,115 in Blackwater, 8,334 in Hook, 4,999 in Hartley Wintney, and 4,610 in Odiham (including North Warnborough area).

5.5 The Policy aim is to clearly set out how the Licensing Authorities will promote the four licensing objectives when dealing with licensing matters. The four licensing objectives are:

- Prevention of Crime and Disorder
- Public Safety
- Prevention of Public Nuisance
- Protection of Children from Harm

5.6 The Licensing Authorities will regulate licensable activities at licensed and unlicensed premises in the combined interests of the public and licensed trades and recognises that these activities contribute to the quality of lives of the areas covered by this policy's residents, businesses and visitors and help support the local economy.

5.7 To achieve this aim, the Licensing Authority is committed to partnership working with the responsible authorities, local businesses, licensing trade, residents, those involved in the protection of children and other interested parties towards the promotion of the objectives. The Licensing Authority will ensure that it takes into account the views of these stakeholders and ensure proper integration of local crime prevention, planning, transport, employment, tourism and cultural strategies.

5.8 The Licensing Authorities aims to balance the protection of the amenity of the local population with the expectations and ability of local businesses to operate in an environment that is attractive and sustainable for their business. The Policy aims to minimise the impacts of licensable activities on residents, visitors, stakeholders and the environment.

5.9 This Policy aims to guide applicants, residents and other persons on the general approach that the council will take to licensing applications and other related issues. Although each application will be considered individually on its own merits, this Policy indicates the wider considerations that will be taken into account when determining applications. However, it is not the Council's intention in adopting this Policy to override the right of any person to make an application and have it considered on its merit.

6.6 **Supermarkets and other 'off' licensed premises selling alcohol.** The Licensing Authorities will generally consider licensing shops, stores and supermarkets to sell alcohol

for consumption off the premises throughout opening times. However, where there are reasons for restricting or amending hours, for example, where premises become the focus of disorder and disturbance, such restrictions or amendments will be considered where relevant representations have been made.

6.7 All 'off' licensed premises must comply with the *Licensing Act 2003 Mandatory Conditions Order* in relation to age related sales. The Licensing Authority also expects such premises to implement additional measures to prevent and deter **proxy** sales on behalf of under 18's.

6.8 Licensees should ensure consideration is given to refusing sales of alcohol to customers who can be clearly identified as having an alcohol related health condition and who may be a source of nuisance or annoyance through street drinking.

6.9 The Licensing Authorities expect adequate checks to be made and all reasonable steps taken to ensure alcohol delivered by way of online shopping services (as provided by most large supermarket chains) is not delivered to minors to prevent a risk of underage consumption.

6.10 Where self-pay till points are made available in stores selling alcohol, provision must be included for alcohol sales to be identified and approved prior to completion of the purchase.

6.11 Designated Premises Supervisor (DPS) at alcohol licensed premises.

Whilst this role has a limited definition under the Licensing Act 2003, it is expected that this person nominated on a licence will have overall responsibility for the day to day management and control of the licensed premises and in particular be responsible for the safe receipt, storage and sale of alcohol.

6.12 The Licensing Authorities would expect the DPS to be onsite at the licensed premises for the majority of time when alcohol is being sold subject to working hours' legislation and absence for sickness and holidays. The Licensing Authorities expect the DPS to provide training to staff in relation to alcohol sales and to authorise the employees the DPS considers competent to sell alcohol on their behalf in writing.

6.13 The Licensing Authorities expects that a DPS should have responsibility for only one licensed premises at a time to ensure good management of the premises and the licensable activities. Where the same person is a nominated DPS on more than one premises licence and representations are made, the Licensing Authority will wish to satisfy itself that the premises in question can properly be managed by that person whilst responsibly promoting the licensing objectives.

7 RESPONSIBLE AUTHORITIES AND OTHER PERSONS

7.1 Responsible authorities are public bodies that are statutory consultees that must be notified of applications by the applicant. The full list and contact details can be found at Appendix A of this Licensing Statement and are contained on the Councils website.

7.2 When dealing with applications for licences and reviews of premises licenses, the Licensing Authorities are obliged to consider representations from two categories of

persons, referred to as 'Responsible Authorities' and 'Other Persons'. This allows for a broad range of persons including ward councillors to comment both for and against applications for premises licences and club premises certificates and for reviews.

7.3 The Licensing Authorities may only consider representations that are relevant, in that they relate to the promotion of the licensing objectives, or that they raise issues in relation to this Statement of Licensing Policy or Home Office Guidance.

7.6 Where an 'Other Person or Persons' request to be represented when seeking to make a representation, the Licensing Authority will require written evidence from the person/s being represented that they have authorised a third party to speak or write on their behalf.

7.7 The Licensing Authorities will examine closely all representations to ensure that they are not frivolous, repetitive or vexatious. Matters that this authority will look at are likely to include:

- Who is making the representation, and whether there is a history of making representations that are not relevant or which have been previously considered vexatious or frivolous
- Whether the representation raises a 'relevant' issue
- Whether the representation raises issues specifically to do with the premises and/or the licensable activities that are the subject of the application.

7.8 The above considerations are not exhaustive, and the Licensing Authorities will have regard to anything a person making a representation, or persons representing them, say about his or her status to make representations. Nothing in this Policy should be taken to undermine the right of any person to make a representation on an application or to seek a review of a licence where provision to do so exists.

8 LICENSING AUTHORITIES' POLICY APPROACH TO LICENSING IN FLEET TOWN CENTRE

8.7 Fleet Town Centre is concentrated along (and off) the length of Fleet Road and house the majority of the late night economy premises and offers a cultural mix of restaurants, bars and pubs with live and recorded music, and a range of menus.

8.8 The Town Centre currently contains several alcohol led premises that trade until 03.30hrs. The Council will carefully consider the impacts of any new or variation applications for late hours for premises within this area that may arise at any time to ensure the character of the locality is retained. However, a presumption will be made to grant hours no later than between 12 midnight and 2 am along Fleet Road.

8.8 The Licensing Authority will expect all applicants for new licences and for variations to existing licences in the Town Centre area to include a detailed operating schedule within the application to ensure that their new business or changes to the operation of their business enhances and compliments the existing style and characteristics of the Top of Town and does not create a negative impact.

8.9 Where matters of concern arise from an application which generates representations, the Licensing Authority will, where appropriate control, or restrict trading hours and/or activities and impose appropriate and proportionate licence conditions to adequately

mitigate those concerns where evidence supports such control in order to promote the licensing objectives.

8.10 Where noise nuisance arises from customers some distance from licensed premises affecting local residents which is caused by customers leaving the late night premises, the council may use its powers under the Environmental Protection Act 1990 where evidence is obtained of statutory nuisance.

11 HUMAN RIGHTS AND EQUAL OPPORTUNITIES

11.1 The Human Rights Act 1998 makes it unlawful for a local authority to act in a way which is incompatible with the European Convention on Human Rights. In making decisions and determining appropriate action the council will have due regard to the Convention. The Licensing Authority will interpret the LA2003 in a manner consistent with the Human Rights Act 1998.

11.2 The Council will consider the effect upon people's human rights and adopt a principle of proportionality and the need to balance the rights of the individual with the rights of the community as a whole. Action taken by the council which affects another's rights must be no more onerous than is necessary in a democratic society.

11.3 The Equality Act 2010 requires public bodies to consider all individuals when carrying out their day to day work – in shaping Policy, in delivering services and in relation to their own employees. It requires public bodies to have due regard to the need to eliminate discrimination, advance equality of opportunity, and foster good relations between different people when carrying out their activities.

11.4 The Equality Duty supports good decision making – it encourages public bodies to understand how different people will be affected by their activities, so that their policies and services are appropriate and accessible to all and meet different people's needs. By understanding the effect of their activities on different people, and how inclusive public services can support and open up people's opportunities, public bodies can be more efficient and effective. The Equality Duty therefore helps public bodies to deliver the Government's overall objectives for public services.

12 COMPLIANCE AND ENFORCEMENT

12.1 There are a range of other offences detailed under Part 7 of the Licensing Act 2003. The Licensing Authority will liaise with the Responsible Authorities to determine enforcement of specific offences on a case by case basis. Offences related to sales of alcohol to minors will be enforced by the Police or Trading Standards Authority unless they form part of a range of offences identified by the Licensing Authority.

12.2 The Licensing Authorities have an approved Licensing Enforcement Policy which complies with the Regulatory Compliance Code and is available on the Council's website.

12.3 A risk-based inspection programme is in place, which includes the targeting of high risk premises which require greater attention, whilst operating a lighter touch in respect of low risk and well managed premises. The risk-based approach is based on Home Office Guidance; the activities authorised and premises compliance history.

12.4 The Licensing Authority has established protocols with the local Police on enforcement issues where necessary. This enables the more efficient deployment of council staff and Police officers who are commonly engaged in enforcing licensing Law and the inspection of licensed premises. Where necessary, inspections will be carried out jointly. The aims of the protocol are to target agreed problem and high risk premises which require greater attention whilst providing a lighter touch in respect of low risk premises which are well run.

PART B

CONSIDERATION OF APPLICATIONS

14 NEW PREMISES LICENCES

14.1 This Licensing Authority is aware that in making decisions about applications for licences it will have regard to:

- Its statement of licensing policy made under section 5 of the Licensing Act 2003
- The statutory guidance issued under section 182 of the Licensing Act 2003, and that decisions made are reasonably consistent with the four licensing objectives.

14.2 Details on the application process can be found on the Council's website.

14.3 Where elements of applications are unclear or unspecific, particularly in relation to operating schedules and trading hours, the Licensing Authority will expect the applicants to provide additional clarity on a request from the licensing team.

14.4 Licensing officers will routinely check that the Public Notices at the premises and the Public Notices in newspapers are displayed in accordance with the regulations as part of the validation process.

14.5 Licensing officers will also notify ward councillors to whose ward the application relates, and the parish council for the relevant parish.

14.6 Where there are no representations about an application the licence will be automatically granted after 28 days under the terms and conditions applied for. Licensing officers will interpret the detail of the operating schedule and convert that into licence conditions.

14.7 Where relevant representations are received the application will be referred to the Licensing Sub-committee for determination at hearing, unless all parties agree that a hearing is not necessary. Where applications result in the need for a hearing the process at section 22 of this policy will apply.

22 HEARINGS

22.1 Any application that has resulted in the submission of relevant representations from any party will be referred to the Licensing Sub-Committee for a hearing and determination in accordance with the 2003 Act and the Licensing Act 2003 (Hearings) Regulations 2005.

22.2 A sub-committee will consist of 3 suitably trained members of the Licensing Committee. No members will serve on a sub-committee involving an application for a licence within their own ward. The subcommittee will be advised on the law by a member

of the Council's Legal Services Team. That legal team member will not be involved in the application process to prevent a conflict of interest by ensuring a clear separation of roles.

22.3 This Policy will play a key role in achieving consistency in decision making and will ensure decisions are made in a way which promotes a sustainable leisure economy for the areas covered by this policy.

22.6 Parties will be advised of the hearing date and procedure in advance and in accordance with the statutory process. At all hearings the sub-committee will have regard to the Guidance issued under section 182 of the Act. This authority may use its discretion where there are strong and defensible reasons for departing from the Guidance and where it considers it right to do so. In any such case this authority will clearly express and explain its reasons for doing so.

22.8 All decision notices will be in writing and will include clearly stated reasons to explain a decision on an application.

23 LICENCE CONDITIONS

23.1 A key concept in the Licensing Act is that conditions that are attached to licences or certificates are tailored to suit the individual style and characteristics of the premises and its activities and the impact of those activities. Those conditions will be deemed appropriate and proportionate in order to promote the licensing objectives at that premises.

23.2 This Policy will play a key role in achieving consistency in decision making and will ensure decisions are made in a way which promotes a sustainable leisure economy for the areas covered by this policy.

23.3 Applicants will be expected to include appropriate steps within their operating schedule which will be converted to conditions on a premises licence or club premises certificate. Those steps will be expected to be achievable and relevant to the business in question and will ensure the promotion of each of the four licensing objectives.

23.4 Where applications receive valid representations and are subject to a hearing, the sub-committee will consider the evidence provided within representations, the detail of the application, the nature of the premises and business and only where appropriate will attach conditions to a licence to secure the promotion of the licensing objectives in light of the evidence provided.

23.5 Decisions on individual licence conditions will be made on a case by case basis, and where there are concerns over the effective promotion of the licensing objectives, the applicant will be expected to offer suggestions on how the objectives can be met. This authority will work closely with all parties and the applicant in establishing workable and reasonable conditions for new and variation applications.

23.6 In all cases the Licensing Authority will have regard to the Guidance when considering the implementation of licence conditions. Further information on the Guidance can be found at the Home Office website.

23.7 In all cases conditions will aim to promote the licensing objectives, be unambiguous and enforceable, appropriate to the activities and the business, achievable and applicable to the premises itself and the areas around the premises which is within the licence holders' control.

23.8 The Licensing Authority recognises the need to avoid, so far as possible, duplication with other regulatory systems including Health and Safety at Work, Fire Safety, Food Hygiene and Nuisance Control. However, these regulations may not cover the unique circumstances of some activities and entertainment. In these circumstances, the council may therefore, where necessary, attach conditions to premises licenses for the promotion of the licensing objectives.

23.9 Conditions to promote the Prevention of Crime and Disorder.

Under the Act the Licensing Authority has a duty to promote the licensing objectives, and a further duty under the Crime and Disorder Act 1998 to do all it reasonably can to prevent crime and disorder in the areas covered by this policy.

23.10 The applicant will be expected to detail in their operating schedule how they will prevent crime and disorder on and close to the premises. Such detail should reflect the licensable activities on offer, location and character of the area, the nature of the premises use and the range of customers likely to use the premises.

These may include, but are not limited to, the following:

- Prevention of disorderly conduct and anti-social behaviour • Prevention of underage drinking
- Prevention of sales of alcohol to intoxicated customers
- Prevention of drunkenness both on and in the vicinity of the premises
- Prevention of drug use and drug dealing • Restriction of drinks promotions
- Use of safety glass
- Inclusion of a wind-down time following alcohol sales period • Adequate seating to discourage "vertical drinking"
- The offer of food and snacks or other entertainment or occupation to discourage persistent drinking
- Prevention of noise nuisance by customers waiting to enter a premises and on leaving

23.15 The use of CCTV should be considered where appropriate or on the advice and recommendations of the Police and to a quality and standard approved by the Police for evidence purposes. Licence holders will be expected to fully comply with the requirements of the Information Commissioners Office and the Data Protection Act 1998 in respect of any surveillance equipment installed at a premises

23.17 Conditions to promote Public Safety.

The applicant will be expected to show that the physical safety of persons attending the premises will be protected and will offer relevant steps in the operating schedule to promote this.

23.18 Such steps will not replace the statutory obligation on the applicant to comply with all relevant legislation under the Health and Safety at Work etc. Act 1973 or under the Regulatory Reform (Fire Safety) Order 2004.

23.20 Conditions to promote the Prevention of Public Nuisance. The applicant will be expected to detail steps to prevent nuisance and disturbance arising from the licensable activities at the premises and from the customers using the premises

23.10 The applicant will be expected to demonstrate that they have considered the following and included steps to prevent public nuisance:

- Proximity of local residents to the premises
- Licensable activities proposed and customer base
- Hours and nature of operation
- Risk and Prevention of noise leakage from the premises from equipment, customers and machinery
- Prevention of noise from customers leaving the premises and customer pick up points outside premises and from the Car Park.
- Availability of public transport to and from the premises
- Noise from use of the garden/outside space including smoking shelters.
- Delivery and collection times and locations.
- Impact of external security or general lighting on residents.
- Outcomes of discussions with the relevant Responsible Authorities.
- Impact of location, noise and contamination from outside smoking areas on neighbours and other customers
- Collection of litter arising from the premises

23.23 Steps will differ depending on the individual premises and activities and it is for the applicant to ensure that reasonable, effective and appropriate steps are included within the operating schedule.

23.24 Conditions to promote the Protection of Children from Harm.

Applicants will be expected to detail steps to protect children at the premises from any harm. The Licensing Authority recognises the right of licensees (serving alcohol) to allow accompanied children into their premises. The Licensing Authority would not seek to restrict access by children (above that specified in the Act) unless it is necessary for the prevention of physical, moral, or psychological harm.

Licensing objectives and aims

1.2 The legislation provides a clear focus on the promotion of four statutory objectives which must be addressed when licensing functions are undertaken. 1.3 The licensing objectives are:

- The prevention of crime and disorder;
- Public safety;
- The prevention of public nuisance; and
- The protection of children from harm.

1.4 Each objective is of equal importance. There are no other statutory licensing objectives, so that the promotion of the four objectives is a paramount consideration at all times.

1.5 However, the legislation also supports a number of other key aims and purposes. These are vitally important and should be principal aims for everyone involved in licensing work. They include:

- protecting the public and local residents from crime, anti-social behaviour and noise nuisance caused by irresponsible licensed premises;
- giving the police and licensing authorities the powers they need to effectively manage and police the night-time economy and take action against those premises that are causing problems;
- recognising the important role which pubs and other licensed premises play in our local communities by minimising the regulatory burden on business, encouraging innovation and supporting responsible premises;
- providing a regulatory framework for alcohol which reflects the needs of local communities and empowers local authorities to make and enforce decisions about the most appropriate licensing strategies for their local area; and
- encouraging greater community involvement in licensing decisions and giving local residents the opportunity to have their say regarding licensing decisions that may affect them.

The guidance

1.6 Section 182 of the 2003 Act provides that the Secretary of State must issue and, from time to time, may revise guidance to licensing authorities on the discharge of their functions under the 2003 Act. This revised guidance takes effect as soon as it is published. Where a licence application was made prior to the publication of the revised guidance, it should be processed in accordance with the guidance in effect at the time at which the application was made; the revised guidance does not apply retrospectively. However, all applications received by the licensing authority on or after the date the revised guidance was published should be processed in accordance with the revised guidance.

Purpose

1.7 This Guidance is provided to licensing authorities in relation to the carrying out of their functions under the 2003 Act. It also provides information to magistrates' courts

hearing appeals against licensing decisions and has been made widely available for the benefit of those who run licensed premises, their legal advisers and the general public. It is a key medium for promoting best practice, ensuring consistent application of licensing powers across England and Wales and for promoting fairness, equal treatment and proportionality.

1.8 The police remain key enforcers of licensing law. This Guidance does not bind police officers who, within the parameters of their force orders and the law, remain operationally independent. However, this Guidance is provided to support and assist police officers in interpreting and implementing the 2003 Act in the promotion of the four licensing objectives.

Legal status

1.9 Section 4 of the 2003 Act provides that, in carrying out its functions, a licensing authority must 'have regard to' guidance issued by the Secretary of State under section 182. This Guidance is therefore binding on all licensing authorities to that extent. However, this Guidance cannot anticipate every possible scenario or set of circumstances that may arise and, as long as licensing authorities have properly understood this Guidance, they may depart from it if they have good reason to do so and can provide full reasons. Departure from this Guidance could give rise to an appeal or judicial review, and the reasons given will then be a key consideration for the courts when considering the lawfulness and merits of any decision taken.

1.10 Nothing in this Guidance should be taken as indicating that any requirement of licensing law or any other law may be overridden (including the obligations placed on any public authorities under human rights legislation). This Guidance does not in any way replace the statutory provisions of the 2003 Act or add to its scope and licensing authorities should note that interpretation of the 2003 Act is a matter for the courts. Licensing authorities and others using this Guidance must take their own professional and legal advice about its implementation.

Licensing policies

1.11 Section 5 of the 2003 Act requires a licensing authority to determine and publish a statement of its licensing policy at least once every five years. The policy must be published before it carries out any licensing functions under the 2003 Act.

1.12 However, determining and publishing a statement of its policy is a licensing function and as such the authority must have regard to this Guidance when taking this step. A licensing authority may depart from its own policy if the individual circumstances of any case merit such a decision in the interests of the promotion of the licensing objectives. But once again, it is important that it should be able to give full reasons for departing from its published statement of licensing policy. Where revisions to this Guidance are issued by the Secretary of State, there may be a period of time when the licensing policy statement is inconsistent with the Guidance (for example, during any consultation by the licensing authority). In these circumstances, the licensing authority should have regard, and give appropriate weight, to this Guidance and its own existing licensing policy statement.

Licensable activities

1.13 For the purposes of the 2003 Act, the following are licensable activities:

- The sale by retail of alcohol;
- The supply of alcohol by or on behalf of a club to, or to the order of, a member of the club;
- The provision of regulated entertainment; and
- The provision of late night refreshment.

Further explanation of these terms is provided in Chapter 3.

General principles

1.15 If an application for a premises licence or club premises certificate has been made lawfully and there have been no representations from responsible authorities or other persons, the licensing authority must grant the application, subject only to conditions that are consistent with the operating schedule and relevant mandatory conditions. It is recommended that licence applicants contact responsible authorities when preparing their operating schedules.

Licence conditions – general principles

1.16 Conditions on a premises licence or club premises certificate are important in setting the parameters within which premises can lawfully operate. The use of wording such as “must”, “shall” and “will” is encouraged. Licence conditions:

- must be appropriate for the promotion of the licensing objectives;
- must be precise and enforceable;
- must be unambiguous and clear in what they intend to achieve;
- should not duplicate other statutory requirements or other duties or responsibilities placed on the employer by other legislation;
- must be tailored to the individual type, location and characteristics of the premises and events concerned;
- should not be standardised and may be unlawful when it cannot be demonstrated that they are appropriate for the promotion of the licensing objectives in an individual case;
- should not replicate offences set out in the 2003 Act or other legislation;
- should be proportionate, justifiable and be capable of being met;
- cannot seek to manage the behaviour of customers once they are beyond the direct management of the licence holder and their staff, but may impact on the behaviour of customers in the immediate vicinity of the premises or as they enter or leave; and
- should be written in a prescriptive format.

Each application on its own merits

1.17 Each application must be considered on its own merits and in accordance with the licensing authority’s statement of licensing policy; for example, if the application falls within the scope of a cumulative impact policy. Conditions attached to licences and certificates must be tailored to the individual type, location and characteristics of the premises and events concerned. This is essential to avoid the imposition of disproportionate and overly burdensome conditions on premises where there is no need for such conditions. Standardised conditions should be avoided and indeed may be unlawful where they cannot be shown to be appropriate for the promotion of the licensing objectives in an individual case.

Other relevant legislation

1.19 While licence conditions should not duplicate other statutory provisions, licensing authorities and licensees should be mindful of requirements and responsibilities placed on them by other legislation. Legislation which may be relevant includes:

- The Gambling Act 2005
- The Environmental Protection Act 1990
- The Noise Act 1996
- The Clean Neighbourhoods and Environmental Act 2005
- The Regulatory Reform (Fire Safety) Order 2005
- The Health and Safety at Work etc. Act 1974
- The Equality Act 2010
- The Immigration Act 2016
- Regulators' Code under the Legislative and Regulatory Reform Act 2006

Crime and disorder

2.1 Licensing authorities should look to the police as the main source of advice on crime and disorder. They should also seek to involve the local Community Safety Partnership (CSP).

2.3 Conditions should be targeted on deterrence and preventing crime and disorder including the prevention of illegal working in licensed premises (see paragraph 10.10). For example, where there is good reason to suppose that disorder may take place, the presence of closed-circuit television (CCTV) cameras both inside and immediately outside the premises can actively deter disorder, nuisance, anti-social behaviour and crime generally. Some licence holders may wish to have cameras on their premises for the prevention of crime directed against the business itself, its staff, or its customers. But any condition may require a broader approach, and it may be appropriate to ensure that the precise location of cameras is set out on plans to ensure that certain areas are properly covered and there is no subsequent dispute over the terms of the condition.

Public safety

2.7 Licence holders have a responsibility to ensure the safety of those using their premises, as a part of their duties under the 2003 Act. This concerns the safety of people using the relevant premises rather than public health which is addressed in other legislation. Physical safety includes the prevention of accidents and injuries and other immediate harms that can result from alcohol consumption such as unconsciousness or alcohol poisoning. Conditions relating to public safety may also promote the crime and disorder objective as noted above. There will of course be occasions when a public safety condition could incidentally benefit a person's health more generally, but it should not be the purpose of the condition as this would be outside the licensing authority's powers (be ultra vires) under the 2003 Act. Conditions should not be imposed on a premises licence or club premises certificate which relate to cleanliness or hygiene.

2.8 A number of matters should be considered in relation to public safety. These may include:

- Fire safety;
- Ensuring appropriate access for emergency services such as ambulances;
- Good communication with local authorities and emergency services, for example communications networks with the police and signing up for local incident alerts (see paragraph 2.4 above);

- Ensuring the presence of trained first aiders on the premises and appropriate first aid kits;
- Ensuring the safety of people when leaving the premises (for example, through the provision of information on late-night transportation);
- Ensuring appropriate and frequent waste disposal, particularly of glass bottles;
- Ensuring appropriate limits on the maximum capacity of the premises (see paragraphs 2.12-2.13, and Chapter 10; and
- Considering the use of CCTV in and around the premises (as noted in paragraph 2.3 above, this may also assist with promoting the crime and disorder objective).

2.9 The measures that are appropriate to promote public safety will vary between premises and the matters listed above may not apply in all cases. As set out in Chapter 8 (8.38-8.46), applicants should consider when making their application which steps it is appropriate to take to promote the public safety objective and demonstrate how they achieve that.

Public nuisance

2.15 The 2003 Act enables licensing authorities and responsible authorities, through representations, to consider what constitutes public nuisance and what is appropriate to prevent it in terms of conditions attached to specific premises licences and club premises certificates. It is therefore important that in considering the promotion of this licensing objective, licensing authorities and responsible authorities focus on the effect of the licensable activities at the specific premises on persons living and working (including those carrying on business) in the area around the premises which may be disproportionate and unreasonable. The issues will mainly concern noise nuisance, light pollution, noxious smells and litter.

2.16 Public nuisance is given a statutory meaning in many pieces of legislation. It is however not narrowly defined in the 2003 Act and retains its broad common law meaning. It may include in appropriate circumstances the reduction of the living and working amenity and environment of other persons living and working in the area of the licensed premises. Public nuisance may also arise as a result of the adverse effects of artificial light, dust, odour and insects or where its effect is prejudicial to health.

2.17 Conditions relating to noise nuisance will usually concern steps appropriate to control the levels of noise emanating from premises. This might be achieved by a simple measure such as ensuring that doors and windows are kept closed after a particular time, or persons are not permitted in garden areas of the premises after a certain time. More sophisticated measures like the installation of acoustic curtains or rubber speaker mounts to mitigate sound escape from the premises may be appropriate. However, conditions in relation to live or recorded music may not be enforceable in circumstances where the entertainment activity itself is not licensable (see chapter 16). Any conditions appropriate to promote the prevention of public nuisance should be tailored to the type, nature and characteristics of the specific premises and its licensable activities. Licensing authorities should avoid inappropriate or disproportionate measures that could deter events that are valuable to the community, such as live music. Noise limiters, for example, are expensive to purchase and install and are likely to be a considerable burden for smaller venues.

2.18 As with all conditions, those relating to noise nuisance may not be appropriate in certain circumstances where provisions in other legislation adequately protect those living in the area of the premises. But as stated earlier in this Guidance, the approach of licensing authorities and responsible authorities should be one of prevention and when their powers are engaged, licensing authorities should be aware of the fact that other legislation may not adequately cover concerns raised in relevant representations and additional conditions may be appropriate.

2.19 Where applications have given rise to representations, any appropriate conditions should normally focus on the most sensitive periods. For example, the most sensitive period for people being disturbed by unreasonably loud music is at night and into the early morning when residents in adjacent properties may be attempting to go to sleep or are sleeping. This is why there is still a need for a licence for performances of live music between 11 pm and 8 am. In certain circumstances, conditions relating to noise emanating from the premises may also be appropriate to address any disturbance anticipated as customers enter and leave.

2.20 Measures to control light pollution will also require careful thought. Bright lighting outside premises which is considered appropriate to prevent crime and disorder may itself give rise to light pollution for some neighbours. Applicants, licensing authorities and responsible authorities will need to balance these issues.

2.21 Beyond the immediate area surrounding the premises, these are matters for the personal responsibility of individuals under the law. An individual who engages in anti-social behaviour is accountable in their own right. However, it would be perfectly reasonable for a licensing authority to impose a condition, following relevant representations, that requires the licence holder or club to place signs at the exits from the building encouraging patrons to be quiet until they leave the area, or that, if they wish to smoke, to do so at designated places on the premises instead of outside, and to respect the rights of people living nearby to a peaceful night

Protection of children from harm

2.22 The protection of children from harm includes the protection of children from moral, psychological and physical harm. This includes not only protecting children from the harms associated directly with alcohol consumption but also wider harms such as exposure to strong language and sexual expletives (for example, in the context of exposure to certain films or adult entertainment). Licensing authorities must also consider the need to protect children from sexual exploitation when undertaking licensing functions.

2.26 Licensing authorities and responsible authorities should expect applicants, when preparing an operating schedule or club operating schedule, to set out the steps to be taken to protect children from harm when on the premises.

Offences relating to the sale and supply of alcohol to children

2.32 Licensing authorities are expected to maintain close contact with the police, young offenders' teams and trading standards officers (who can carry out test purchases under section 154 of the 2003 Act) about the extent of unlawful sales and consumption of alcohol by minors and to be involved in the development of any strategies to control or prevent these unlawful activities and to pursue prosecutions. Licensing authorities, alongside the police, are prosecuting authorities for the purposes of these offences, except for the offences under section 147A (persistently selling alcohol to children).

Where, as a matter of policy, warnings are given to retailers prior to any decision to prosecute in respect of an offence, it is important that each of the enforcement arms should be aware of the warnings each of them has given.

3. Licensable activities

Summary

3.1 A premises licence authorises the use of any premises (see Chapter 5) for licensable activities. Licensable activities are defined in section 1 of the 2003 Act, and a fuller description of certain activities is set out in Schedules 1 and 2 to the 2003 Act.

3.2 The licensable activities are:

- the sale by retail of alcohol;
- the supply of alcohol by or on behalf of a club to, or to the order of, a member of the club;
- the provision of regulated entertainment; and
- the provision of late night refreshment.

8. Applications for premises licences

Relevant licensing authority

8.1 Premises licences are issued by the licensing authority in which the premises are situated or, in the case of premises straddling an area boundary, the licensing authority where the greater part of the premises is situated. Where the premises is located equally in two or more areas, the applicant may choose but, in these rare cases, it is important that each of the licensing authorities involved maintain close contact.

8.2 Section 13 of the 2003 Act defines the parties holding important roles in the context of applications, inspection, monitoring and reviews of premises licences.

Other persons

8.13 As well as responsible authorities, any other person can play a role in a number of licensing processes under the 2003 Act. This includes any individual, body or business entitled to make representations to licensing authorities in relation to applications for the grant, variation, minor variation or review of premises licences and club premises certificates, regardless of their geographic proximity to the premises. In addition, these persons may themselves seek a review of a premises licence. Any representations made by these persons must be 'relevant', in that the representation relates to one or more of the licensing objectives. It must also not be considered by the licensing authority to be frivolous or vexatious. In the case of applications for reviews, there is an additional requirement that the grounds for the review should not be considered by the licensing authority to be repetitious. Chapter 9 of this guidance (paragraphs 9.4 to 9.10) provides more detail on the definition of relevant, frivolous and vexatious representations.

8.14 While any of these persons may act in their own right, they may also request that a representative makes the representation to the licensing authority on their behalf. A representative may include a legal representative, a friend, a Member of Parliament, a Member of the Welsh Government, or a local ward or parish councillor who can all act in such a capacity.

Steps to promote the licensing objectives

8.41 In completing an operating schedule, applicants are expected to have regard to the statement of licensing policy for their area. They must also be aware of the expectations of the licensing authority and the responsible authorities as to the steps that are appropriate for the promotion of the licensing objectives, and to demonstrate knowledge of their local area when describing the steps they propose to take to promote the licensing objectives. Licensing authorities and responsible authorities are expected to publish information about what is meant by the promotion of the licensing objectives and to ensure that applicants can readily access advice about these matters. However, applicants are also expected to undertake their own enquiries about the area in which the premises are situated to inform the content of the application.

8.42 Applicants are, in particular, expected to obtain sufficient information to enable them to demonstrate, when setting out the steps they propose to take to promote the licensing objectives, that they understand:

- the layout of the local area and physical environment including crime and disorder hotspots, proximity to residential premises and proximity to areas where children may congregate;
- any risk posed to the local area by the applicants' proposed licensable activities; and
- any local initiatives (for example, local crime reduction initiatives or voluntary schemes including local taxi-marshalling schemes, street pastors and other schemes) which may help to mitigate potential risks.

8.43 Applicants are expected to include positive proposals in their application on how they will manage any potential risks. Where specific policies apply in the area (for example, a cumulative impact assessment), applicants are also expected to demonstrate an understanding of how the policy impacts on their application; any measures they will take to mitigate the impact; and why they consider the application should be an exception to the policy.

8.44 It is expected that enquiries about the locality will assist applicants when determining the steps that are appropriate for the promotion of the licensing objectives. For example, premises with close proximity to residential premises should consider what effect this will have on their smoking, noise management and dispersal policies to ensure the promotion of the public nuisance objective. Applicants must consider all factors which may be relevant to the promotion of the licensing objectives, and where there are no known concerns, acknowledge this in their application.

8.46 While applicants are not required to seek the views of responsible authorities before formally submitting their application, they may find them to be a useful source of expert advice on local issues that should be taken into consideration when making an application. Licensing authorities may wish to encourage co-operation between applicants, responsible authorities and, where relevant, local residents and businesses before applications are submitted in order to minimise the scope for disputes to arise.

8.47 Applicants are expected to provide licensing authorities with sufficient information in this section to determine the extent to which their proposed steps are appropriate to promote the licensing objectives in the local area. Applications must not be based on providing a set of standard conditions to promote the licensing objectives and applicants

are expected to make it clear why the steps they are proposing are appropriate for the premises.

8.48 All parties are expected to work together in partnership to ensure that the licensing objectives are promoted collectively. Where there are no disputes, the steps that applicants propose to take to promote the licensing objectives, as set out in the operating schedule, will very often translate directly into conditions that will be attached to premises licences with the minimum of fuss.

8.49 For some premises, it is possible that no measures will be appropriate to promote one or more of the licensing objectives, for example, because they are adequately covered by other existing legislation. It is however important that all operating schedules should be precise and clear about the consideration given to the licensing objectives and any measures that are proposed to promote them.

General

9.1 When a licensing authority receives an application for a new premises licence or an application to vary an existing premises licence, it must determine whether the application has been made in accordance with section 17 of the 2003 Act, and in accordance with regulations made under sections 17(3) to (6), 34, 42, 54 and 55 of the 2003 Act. It must similarly determine applications for the grant of club premises certificates made in accordance with section 71 of the 2003 Act, and in accordance with regulations made under sections 71(4) to (7), 84, 91 and 92 of the 2003 Act. This means that the licensing authority must consider among other things whether the application has been properly advertised in accordance with those regulations.

Where representations are made

9.3 Where a representation concerning the licensing objectives is made by a responsible authority about a proposed operating schedule and it is relevant (see paragraphs 9.4 to 9.10 below), the licensing authority's discretion will be engaged. It will also be engaged if another person makes relevant representations to the licensing authority, which are also not frivolous or vexatious (see paragraphs 9.4 to 9.10 below). Relevant representations can be made in opposition to, or in support of, an application and can be made by any individual, body or business that has grounds to do so.

Relevant, vexatious and frivolous representations

9.4 A representation is "relevant" if it relates to the likely effect of the grant of the licence on the promotion of at least one of the licensing objectives. For example, a representation from a local businessperson about the commercial damage caused by competition from new licensed premises would not be relevant. On the other hand, a representation by a businessperson that nuisance caused by new premises would deter customers from entering the local area, and the steps proposed by the applicant to prevent that nuisance were inadequate, would be relevant. In other words, representations should relate to the impact of licensable activities carried on from premises on the objectives.

There is no requirement for a responsible authority or other person to produce a recorded history of problems at premises to support their representations, and in fact this would not be possible for new premises.

9.5 It is for the licensing authority to determine whether a representation (other than a representation from a responsible authority) is frivolous or vexatious on the basis of what

might ordinarily be considered to be vexatious or frivolous. A representation may be considered to be vexatious if it appears to be intended to cause aggravation or annoyance, whether to a competitor or other person, without reasonable cause or justification. Vexatious circumstances may arise because of disputes between rival businesses and local knowledge will therefore be invaluable in considering such matters. Licensing authorities can consider the main effect of the representation, and whether any inconvenience or expense caused by it could reasonably be considered to be proportionate.

9.6 Frivolous representations would be essentially categorised by a lack of seriousness. Frivolous representations would concern issues which, at most, are minor and in relation to which no remedial steps would be warranted or proportionate.

9.9 It is recommended that, in borderline cases, the benefit of the doubt about any aspect of a representation should be given to the person making that representation. The subsequent hearing would then provide an opportunity for the person or body making the representation to amplify and clarify it.

9.10 Licensing authorities should consider providing advice on their websites about how any person can make representations to them.

Hearings

9.31 The Licensing Act 2003 (Hearings) Regulations 2005 governing hearings may be found on the www.legislation.gov.uk website. If the licensing authority decides that representations are relevant, it must hold a hearing to consider them. The need for a hearing can only be avoided with the agreement of the licensing authority, where the applicant and all of the persons who made relevant representations have given notice to the authority that they consider a hearing to be unnecessary. Where this is the case and the authority agrees that a hearing is unnecessary, it must forthwith give notice to the parties that the hearing has been dispensed with. Notwithstanding those regulatory provisions, in cases where the licensing authority believes that a hearing is still necessary, it is recommended that the authority should, as soon as possible, provide the parties with reasons in writing for the need to hold the hearing. In cases where only 'positive' representations are received, without qualifications, the licensing authority should consider whether a hearing is required. To this end, it may wish to notify the persons who made representations and give them the opportunity to withdraw those representations. This would need to be done in sufficient time before the hearing to ensure that parties were not put to unnecessary inconvenience.

9.32 Responsible authorities should try to conclude any discussions with the applicant in good time before the hearing. The 2005 Hearings Regulations permit licensing authorities to extend a time limit provided for by those Regulations for a specified period where it considers this to be necessary in the public interest. For example, if the application is amended at the last moment, the licensing committee should consider giving other persons time to address the revised application before the hearing commences. Where the authority has extended a time limit it must forthwith give a notice to the parties involved stating the period of the extension and the reasons for it.

9.33 The 2005 Hearings Regulations require that representations must be withdrawn 24 hours before the first day of any hearing. If they are withdrawn after this time, the hearing must proceed and the representations may be withdrawn orally at that hearing. However, where discussions between an applicant and those making representations

are taking place and it is likely that all parties are on the point of reaching agreement, the licensing authority may wish to use the power given within the hearings regulations to extend time limits, if it considers this to be in the public interest.

9.34 Applicants should be encouraged to contact responsible authorities and others, such as local residents, who may be affected by the application before formulating their applications so that the mediation process may begin before the statutory time limits come into effect after submission of an application. The hearing process must meet the requirements of regulations made under the 2003 Act. Where matters arise which are not covered by the regulations, licensing authorities may make arrangements as they see fit as long as they are lawful.

9.35 There is no requirement in the 2003 Act for responsible authorities that have made representations to attend, but it is generally good practice and assists committees in reaching more informed decisions. Where several responsible authorities within a local authority have made representations on an application, a single local authority officer may represent them at the hearing if the responsible authorities and the licensing authority agree. This local authority officer representing other responsible authorities may be a licensing officer, but only if this licensing officer is acting as a responsible authority on behalf of the licensing authority and has had no role in the licensing determination process. This is to ensure that the responsible authorities are represented by an independent officer separate from the licensing determination process.

9.37 As a matter of practice, licensing authorities should seek to focus the hearing on the steps considered appropriate to promote the particular licensing objective or objectives that have given rise to the specific representation and avoid straying into undisputed areas. A responsible authority or other person may choose to rely on their written representation. They may not add further representations to those disclosed to the applicant prior to the hearing, but they may expand on their existing representation and should be allowed sufficient time to do so, within reasonable and practicable limits.

9.38 In determining the application with a view to promoting the licensing objectives in the overall interests of the local community, the licensing authority must give appropriate weight to:

- the steps that are appropriate to promote the licensing objectives;
- the representations (including supporting information) presented by all the parties;
- this Guidance;
- its own statement of licensing policy.

9.39 The licensing authority should give its decision within five working days of the conclusion of the hearing (or immediately in certain specified cases) and provide reasons to support it. This will be important if there is an appeal by any of the parties. Notification of a decision must be accompanied by information on the right of the party to appeal. After considering all the relevant issues, the licensing authority may grant the application subject to the relevant mandatory conditions and any conditions that are consistent with the operating schedule. Any additional conditions imposed must be appropriate for the promotion of the licensing objectives; there is no power for the licensing authority to attach a condition that is merely aspirational. For example, conditions may not be attached which relate solely to the health of customers rather than their direct physical safety. Any conditions added to the licence must be those imposed at the hearing or those agreed when a hearing has not been necessary.

9.40 Alternatively, the licensing authority may refuse the application on the grounds that this is appropriate for the promotion of the licensing objectives. It may also refuse to specify a designated premises supervisor and/or only allow certain requested licensable activities. In the interests of transparency, the licensing authority should publish hearings procedures in full on its website to ensure that those involved have the most current information.

Determining actions that are appropriate for the promotion of the licensing objectives

9.42 Licensing authorities are best placed to determine what actions are appropriate for the promotion of the licensing objectives in their areas. All licensing determinations should be considered on a case-by-case basis. They should take into account any representations or objections that have been received from responsible authorities or other persons, and representations made by the applicant or premises user as the case may be.

9.43 The authority's determination should be evidence-based, justified as being appropriate for the promotion of the licensing objectives and proportionate to what it is intended to achieve.

9.44 Determination of whether an action or step is appropriate for the promotion of the licensing objectives requires an assessment of what action or step would be suitable to achieve that end. While this does not therefore require a licensing authority to decide that no lesser step will achieve the aim, the authority should aim to consider the potential burden that any condition would impose on the premises licence holder (such as the financial burden due to restrictions on licensable activities) as well as the potential benefit in terms of the promotion of the licensing objectives. However, it is imperative that the authority ensures that the factors which form the basis of its determination are limited to consideration of the promotion of the objectives and nothing outside those parameters. As with the consideration of licence variations, the licensing authority should consider wider issues such as other conditions already in place to mitigate potential negative impact on the promotion of the licensing objectives and the track record of the business. Further advice on determining what is appropriate when imposing conditions on a licence or certificate is provided in Chapter 10. The licensing authority is expected to come to its determination based on an assessment of the evidence on both the risks and benefits either for or against making the determination.

10. Conditions attached to premises licences and club premises certificates

General

10.1 This chapter provides further guidance in relation to conditions attached to premises licences and club premises certificates. General principles on licence conditions are set out in Chapter 1 (see paragraph 1.16).

10.2 Conditions include any limitations or restrictions attached to a licence or certificate and essentially are the steps or actions that the holder of the premises licence or the club premises certificate will be required to take or refrain from taking in relation to the carrying on of licensable activities at the premises in question. Failure to comply with any condition attached to a licence or certificate is a criminal offence, which on conviction is punishable by an unlimited fine or up to six months' imprisonment. The courts have

made clear that it is particularly important that conditions which are imprecise or difficult for a licence holder to observe should be avoided.

10.3 There are three types of condition that may be attached to a licence or certificate: proposed, imposed and mandatory. Each of these categories is described in more detail below.

Consistency with steps described in operating schedule

10.6 The 2003 Act provides that where an operating schedule or club operating schedule has been submitted with an application and there have been no relevant representations made by responsible authorities or any other person, the licence or certificate must be granted subject only to such conditions as are consistent with the schedule accompanying the application and any mandatory conditions required under the 2003 Act.

10.7 Consistency means that the effect of the condition should be substantially the same as that intended by the terms of the operating schedule. If conditions are broken, this may lead to a criminal prosecution or an application for a review and it is extremely important therefore that they should be expressed on the licence or certificate in unequivocal and unambiguous terms. The duty imposed by conditions on the licence holder or club must be clear to the licence holder, club, enforcement officers and the courts.

Imposed conditions

10.8 The licensing authority may not impose any conditions unless its discretion has been exercised following receipt of relevant representations and it is satisfied as a result of a hearing (unless all parties agree a hearing is not necessary) that it is appropriate to impose conditions to promote one or more of the four licensing objectives. In order to promote the crime prevention licensing objective conditions may be included that are aimed at preventing illegal working in licensed premises. This provision also applies to minor variations.

10.9 It is possible that in some cases no additional conditions will be appropriate to promote the licensing objectives.

Proportionality

10.10 The 2003 Act requires that licensing conditions should be tailored to the size, type, location and characteristics and activities taking place at the premises concerned. Conditions should be determined on a case-by-case basis and standardised conditions which ignore these individual aspects should be avoided. For example, conditions should not be used to implement a general policy in a given area such as the use of CCTV, polycarbonate drinking vessels or identity scanners where they would not be appropriate to the specific premises. Conditions that are considered appropriate for the prevention of illegal working in premises licensed to sell alcohol or late night refreshment might include requiring a premises licence holder to undertake right to work checks on all staff employed at the licensed premises or requiring that evidence of a right to work check, either physical or digital (e.g. copy of any document checked or a clear copy of the online right to work check) is retained at the licensed premises. Licensing authorities and other responsible authorities should be alive to the indirect costs that can arise because of conditions. These could be a deterrent to holding events that are valuable to the community or for the funding of good and important causes. Licensing authorities

should therefore ensure that any conditions they impose are only those which are appropriate for the promotion of the licensing objectives.

Naming, packing and promotion in retail premises

10.11 The Government acknowledges that the irresponsible naming, packing or promotion of alcoholic drinks may contribute to alcohol related harms. Where there is direct evidence of specific incidents of irresponsible naming, packing or promotion of alcoholic drinks linked to the undermining of one of the licensing objectives, licensing authorities should, in the exercise of their licensing functions (in particular, in relation to an application for the grant, variation or review of a premises licence), consider whether it is appropriate to impose conditions on licences that require the licence holder to comply with the Portman Group's Retailer Alert Bulletins. This condition should be considered on a case by case basis and in the context of the promotion of the licensing objectives.

10.12 The Portman Group operates, on behalf of the alcohol industry, a Code of Practice on the Naming, Packaging and Promotion of Alcoholic Drinks. The Code seeks to ensure that drinks are packaged and promoted in a socially responsible manner and only to those who are 18 years old or older. Complaints about products under the Code are considered by an Independent Complaints Panel and the Panel's decisions are published on the Portman Group's website, in the trade press and in an annual report. If a product's packaging or point-of-sale advertising is found to be in breach of the Code, the Portman Group may issue a Retailer Alert Bulletin to notify retailers of the decision and ask them not to replenish stocks of any such product or to display such point-of-sale material, until there has been compliance with the decision.

Hours of trading

10.13 The Government acknowledges that different licensing strategies may be appropriate for the promotion of the licensing objectives in different areas. The 2003 Act gives the licensing authority power to make decisions about the hours during which premises can conduct licensable activities as part of the implementation of its licensing policy statement. Licensing authorities are best placed to make decisions about appropriate opening hours in their areas based on their local knowledge and in consultation with responsible authorities. However, licensing authorities must always consider each application and must not impose predetermined licensed opening

10.15 Shops, stores and supermarkets should normally be free to provide sales of alcohol for consumption off the premises at any times when the retail outlet is open for shopping unless there are good reasons, based on the licensing objectives, for restricting those hours.

Mandatory conditions in relation to the supply of alcohol

10.25 The 2003 Act provides for the following mandatory conditions to be included in every licence and/or club premises certificate in the circumstances specified.

Designated premises supervisor

10.26 The 2003 Act provides that, where a premises licence authorises the supply of alcohol, it must include a condition that no supply of alcohol may be made at a time when no designated premises supervisor has been specified in the licence or at a time when the designated premises supervisor does not hold a personal licence or the personal licence has been suspended.

10.27 The main purpose of the 'designated premises supervisor' as defined in the 2003 Act is to ensure that there is always one specified individual among these personal licence holders who can be readily identified for the premises where a premises licence is in force. That person will normally have been given day to day responsibility for running the premises by the premises licence holder. The requirements set out in relation to the designated premises supervisor and authorisation of alcohol sales by a personal licence holder do not apply to community premises in respect of which a successful application has been made to disapply the usual mandatory conditions in sections 19(2) and 19(3) of the 2003 Act (see Chapter 4 of this Guidance).

10.28 The 2003 Act does not require a designated premises supervisor or any other personal licence holder to be present on the premises at all times when alcohol is sold. However, the designated premises supervisor and the premises licence holder remain responsible for the premises at all times including compliance with the terms of the 2003 Act and conditions attached to the premises licence to promote the licensing objectives.

Age verification

10.46 The premises licence holder or club premises certificate holder must ensure that an age verification policy applies to the premises in relation to the sale or supply of alcohol. This must as a minimum require individuals who appear to the responsible person (see paragraph 10.39) to be under the age of 18 years of age to produce on request, before being served alcohol, identification bearing their photograph, date of birth, and either a holographic mark or ultraviolet feature. The Home Office encourages licensed premises to accept cards bearing the Proof of Age Standards Scheme (PASS) hologram as their preferred proof of age, while acknowledging that many other forms of identification meet the requirements of the mandatory condition.

10.47 The premises licence holder or club premises certificate holder must ensure that staff (in particular, staff who are involved in the supply of alcohol) are made aware of the existence and content of the age verification policy which applies to the premises.

10.48 The designated premises supervisor (where there is one) must ensure that the supply of alcohol at the premises is carried on in accordance with the age verification policy. This means that the DPS has personal responsibility for ensuring that staff are not only aware of, but are also applying, the age verification policy.

10.49 It is acceptable, and indeed encouraged, for premises to have an age verification policy which requires individuals who appear to the responsible person to be under an age greater than 18 to produce such identification on request. For example, if premises have a policy that requires any individual that appears to be under the age of 21 to produce identification that meets the criteria listed above, this is perfectly acceptable under the mandatory code.

10.50 Licence holders should consider carefully what steps they are required to take to comply with the age verification requirements under the 2003 Act in relation to sales of alcohol made remotely. These include sales made online, by telephone and mail order sales, and alcohol delivery services. Each of these sales must comply with the requirements of the 2003 Act. The mandatory condition requires that age verification takes place before a person is served alcohol. Where alcohol is sold remotely (for example, online) or through a telephone transaction, the sale is made at this point but the alcohol is not actually served until it is delivered to the customer. Age verification

measures (for example, online age verification) should be used to ensure that alcohol is not sold to any person under the age of 18. However, licence holders should also consider carefully what steps are appropriate to ensure that age verification takes place before the alcohol is served (i.e., physically delivered) to the customer to be satisfied that the customer is aged 18 or over. It is, therefore, the responsibility of the person serving or delivering the alcohol to ensure that age verification has taken place and that photo ID has been checked if the person appears to be less than 18 years of age.

Giving reasons for decisions

13.10 It is important that a licensing authority gives comprehensive reasons for its decisions in anticipation of any appeals. Failure to give adequate reasons could itself give rise to grounds for an appeal. It is particularly important that reasons should also address the extent to which the decision has been made with regard to the licensing authority's statement of policy and this Guidance. Reasons should be promulgated to all the parties of any process which might give rise to an appeal under the terms of the 2003 Act.

13.11 It is important that licensing authorities also provide all parties who were party to the original hearing, but not involved directly in the appeal, with clear reasons for any subsequent decisions where appeals are settled out of court. Local residents in particular, who have attended a hearing where the decision was subject to an appeal, are likely to expect the final determination to be made by a court.

Licensing hours

14.51 With regard to licensing hours, the Government acknowledges that different licensing approaches may be appropriate for the promotion of the licensing objectives in different areas. The 2003 Act gives the licensing authority power to make decisions regarding licensed opening hours as part of the implementation of its licensing policy statement and licensing authorities are best placed to make such decisions based on their local knowledge and in consultation with other responsible authorities. However, licensing authorities must always consider each application and must not impose predetermined licensed opening hours, without giving individual consideration to the merits of each application.

14.52 Statements of licensing policy should set out the licensing authority's approach regarding licensed opening hours and the strategy it considers appropriate for the promotion of the licensing objectives in its area. The statement of licensing policy should emphasise the consideration which will be given to the individual merits of an application. The Government recognises that licensed premises make an important contribution to our local communities and has given councils a range of tools to effectively manage the different pressures that licensed premises can bring. In determining appropriate strategies around licensed opening hours, licensing authorities cannot seek to restrict the activities of licensed premises where it is not appropriate for the promotion of the licensing objectives to do so.